

**MOCSRR0AC010 cm 110**  
**MOCSRR0AL006 cm 110**

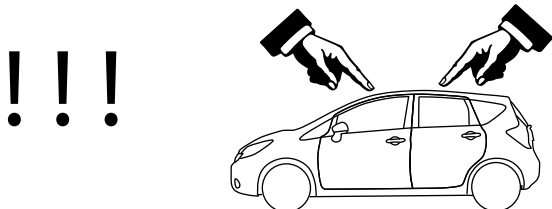

2 - L599/3 ant. 2 - L1061/4	1 - L1209/17 post. dx 1 - L1209/27 post. sx 2 - L1315/6	4 - L1058/7 4 - RC20200026	8 - RCVM6X9Q 1 - RCBR5
--------------------------------	---	-------------------------------	---------------------------

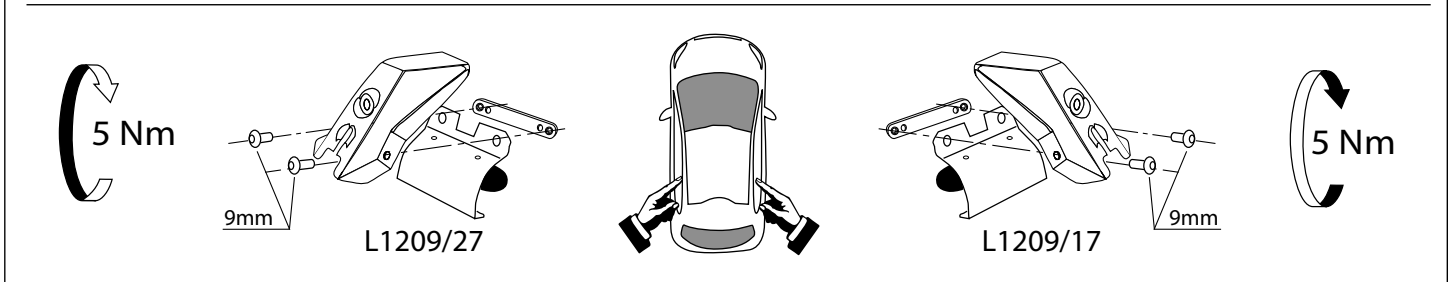
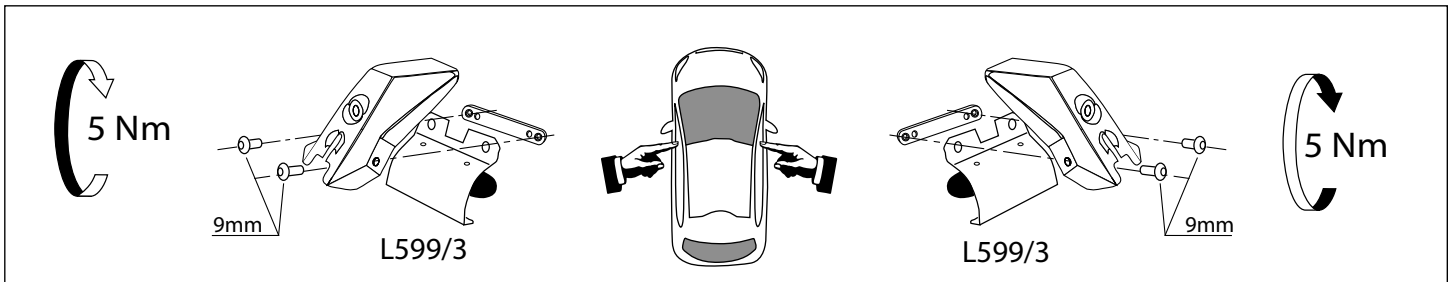
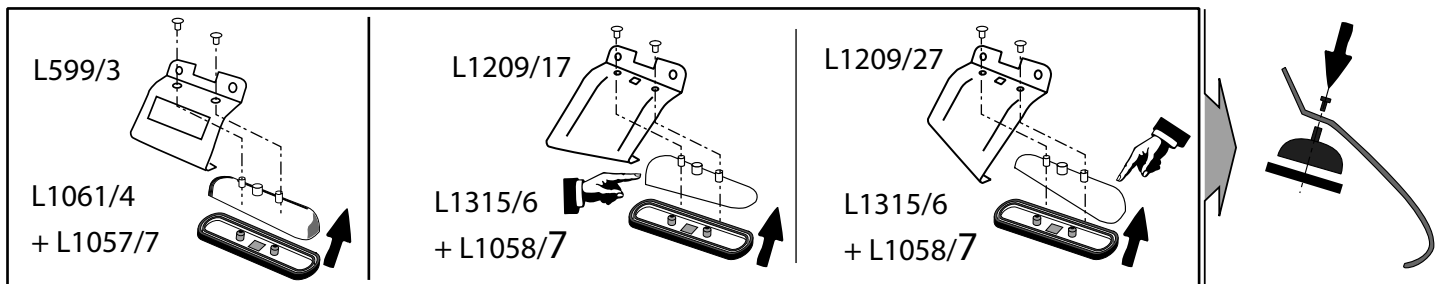

**MOCSRR0AC010 cm 110**  
**MOCSRR0AL006 cm 110**

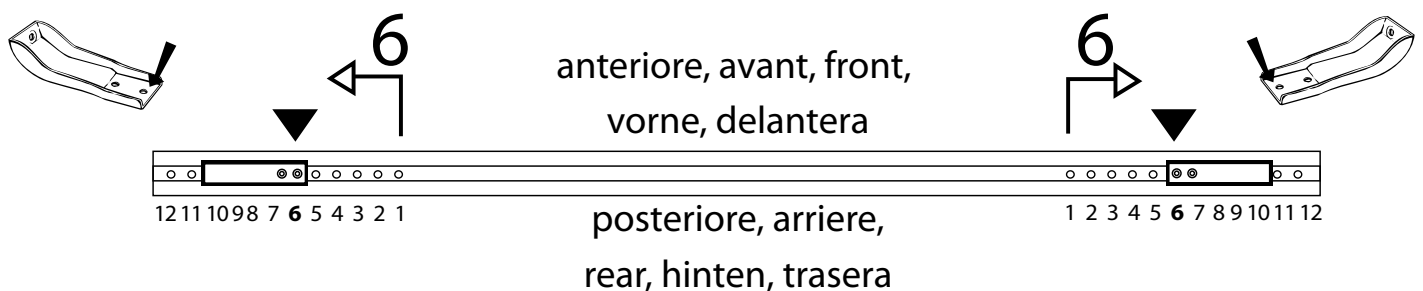

# MOCSKT 0450

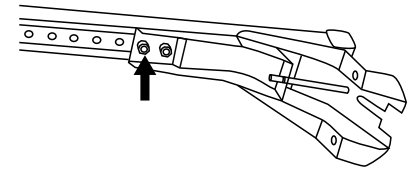
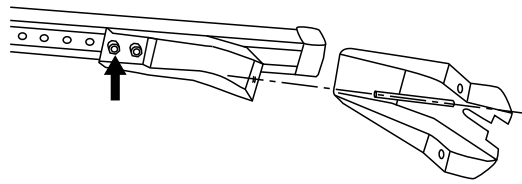
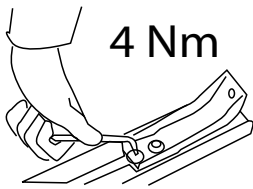

L599/3 +  
L1061/4



L599/3 +  
L1061/4

L1209/27 +  
L1315/6

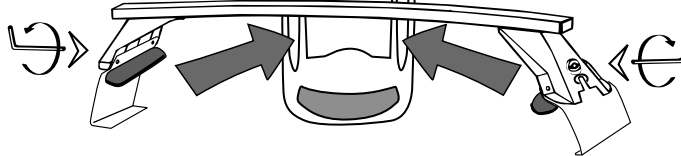

L1209/17 +  
L1315/6

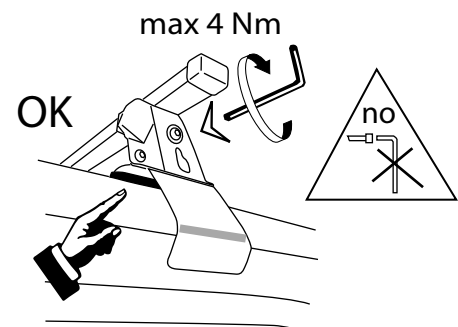
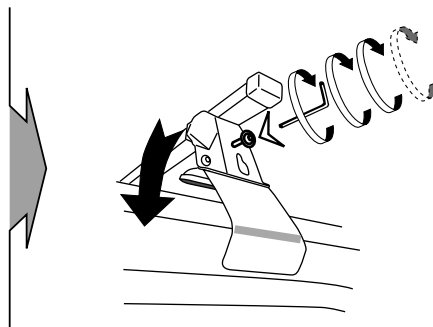
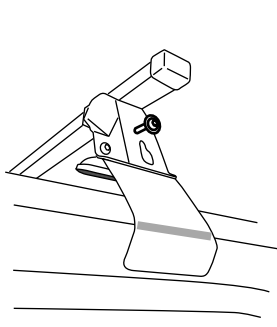
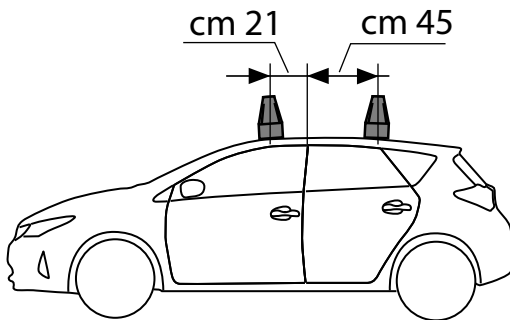

I - Per stringere, usare la chiave come indicato nel disegno. (Non si assumono responsabilità per danni causati dall'impiego di chiavi diverse da quella in dotazione al prodotto).

F - Pour serrer, utiliser la clé comme indique ci dessous.

GB - To tighten please use the wrench as per the drawing.

D - Zum Anziehen benutzen Sie bitte den Inbusschlüssel, nur wie auf dem Bild dargestellt.

E - Para el correcto ajuste, utilizar la llave fija tal y como se indica en la imagen

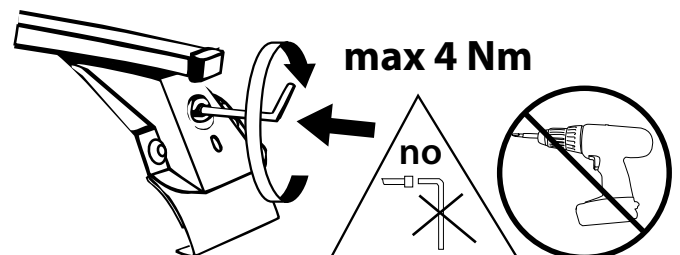

**MODULA**  
case system

email: [modulacs@modulacs.com](mailto:modulacs@modulacs.com)  
web site: [www.modulacs.com](http://www.modulacs.com)

Modula s.r.l.  
Loc. Penisola, 20/A  
61026 Piandimeleto (PU) ITALY  
phone +39 0722/700070  
fax +39 0722/720017

03-12-2021