

MOCSRROAL007 cm 124

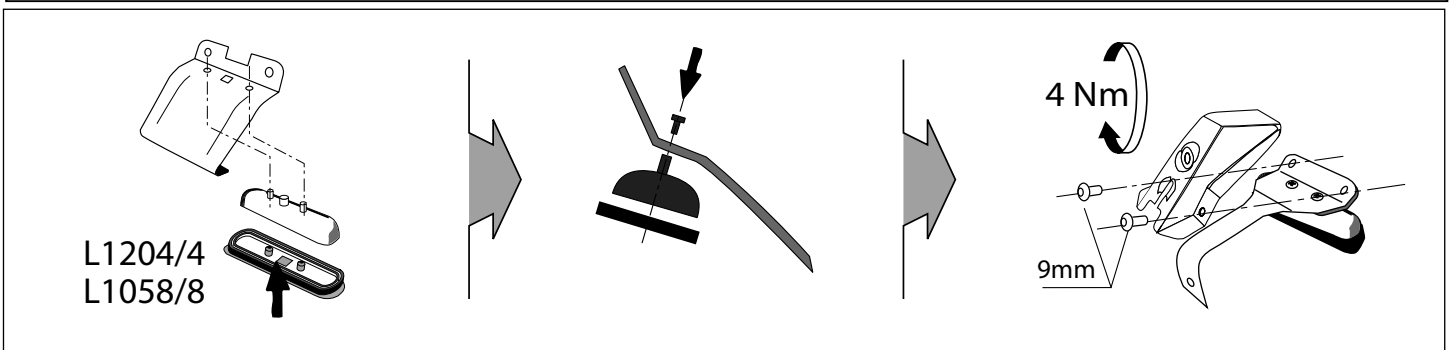

4 - L1110		8 - RCVM6X9Q	
4 - L1204/4		2 - RCVM6X14Q	
4 - L1058/8		4 - RC20200026	
		1 - RCBR5	



MOCSRROAC0011 cm 124



anteriore, avant, front,
vorne, delantera



posteriore, arriere,
rear, hinten, trasera

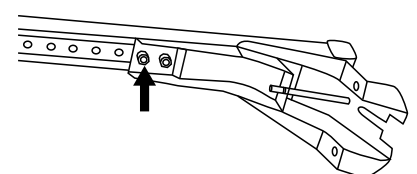
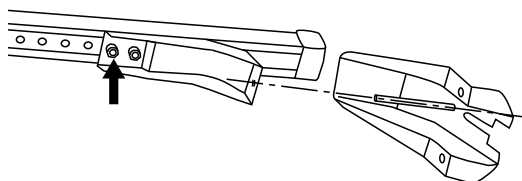
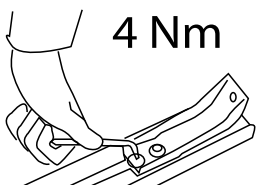

MOCSKT 0436

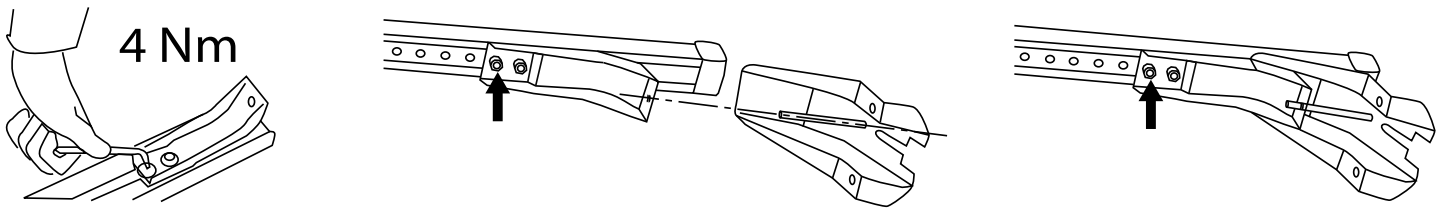

cm 17

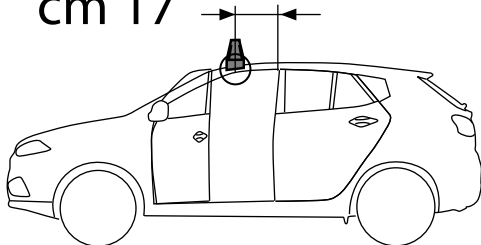

cm 50

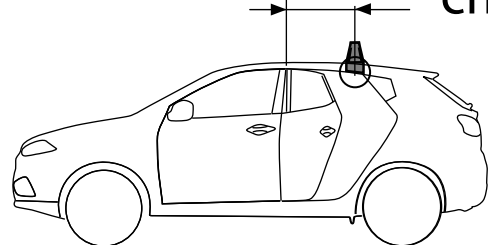

L1110 +
L1204/4

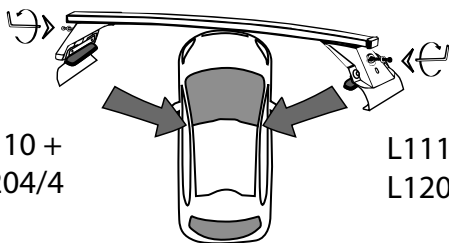

L1110 +
L1204/4

L1110 +
L1204/4

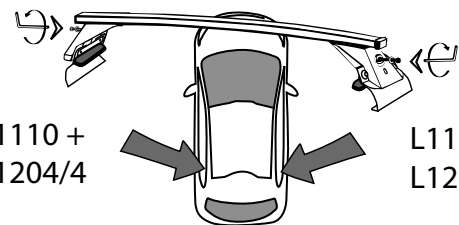

L1110 +
L1204/4

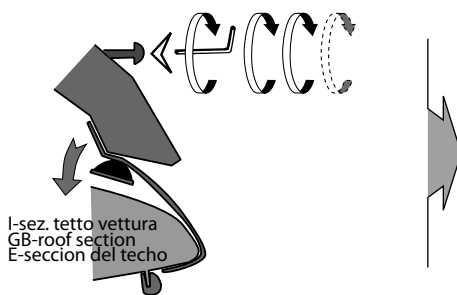

I-sez. tetto vettura
GB-roof section
E-section del techo

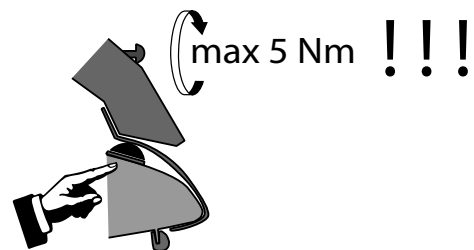

max 5 Nm !!!

I - Per stringere, usare la chiave come indicato nel disegno. (Non si assumono responsabilità per danni causati dall'impiego di chiavi diverse da quella in dotazione al prodotto).
F - Pour serrer, utiliser la clé comme indiqué ci dessous.

GB - To tighten please use the wrench as per the drawing.
D - Zum Anziehen benutzen Sie bitte den Inbusschlüssel, nur wie auf dem Bild dargestellt.
E - Para el correcto ajuste, utilizar la llave fija tal y como se indica en la imagen

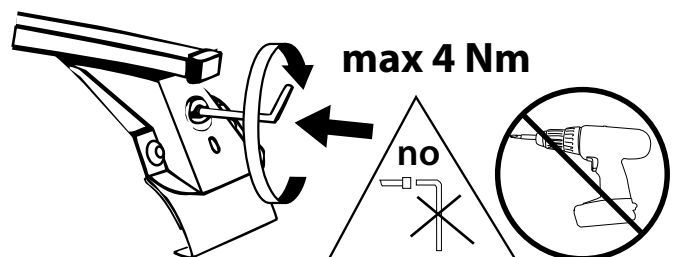

max 4 Nm