









KIA Proceed model 2019

MOCSKT 0397

MOCSRR0AC0011 cm 124

MOCSRR0AL0007 cm 124

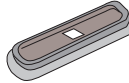
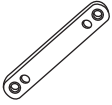

<p>1 - L1169/17 ant. sx</p> 	<p>1 - L1151/45 post. sx</p> 	<p>4 - L1204/4</p> 	<p>8 - RCVM6X9Q</p> 
<p>1 - L1169/27 ant. dx</p> 	<p>1 - L1151/35 post. dx</p> 	<p>4 - L1058/8</p> 	<p>4 - RC20200026</p> 
			<p>1 - RCBR5</p> 

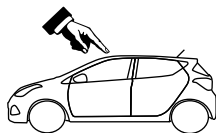
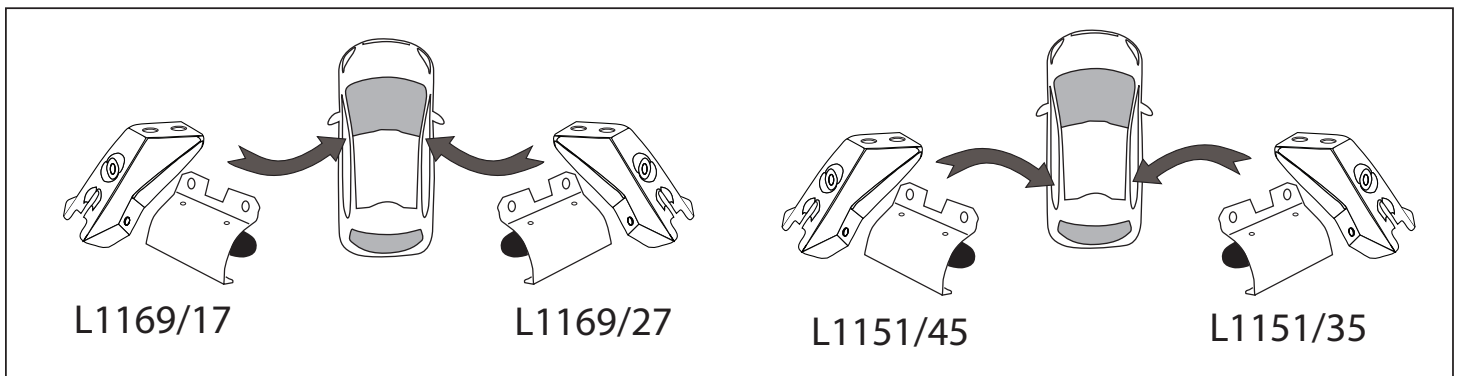
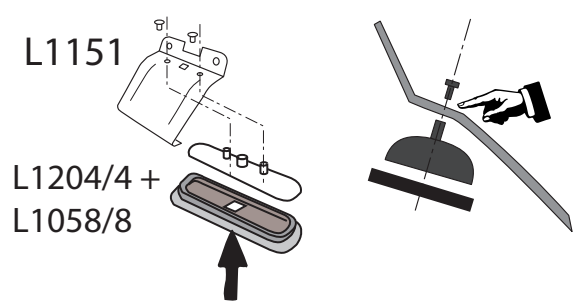
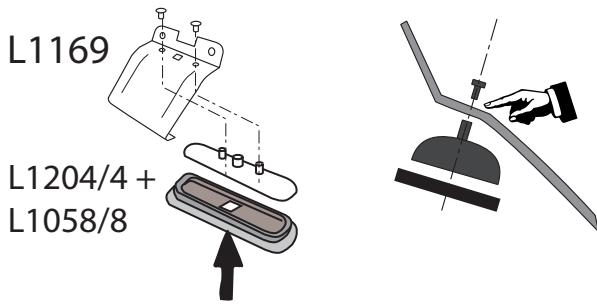

MOCSRR0AC0011 cm 124
MOCSRR0AL0007 cm 124

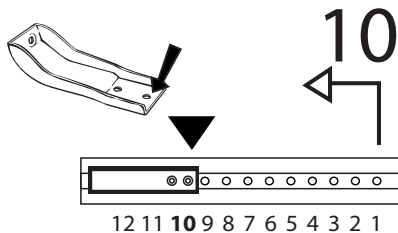

anteriore, avant, front,
vorne, delantera

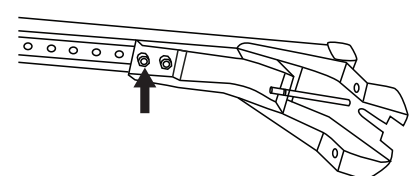
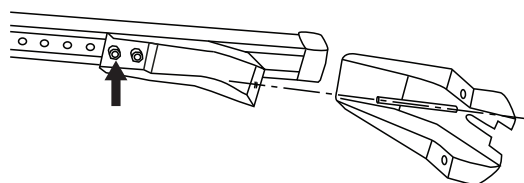
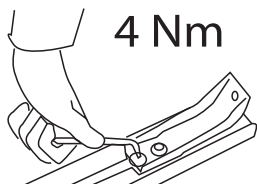
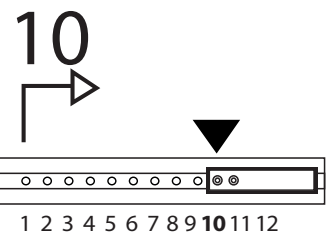

MOCSKT 0397

!!!

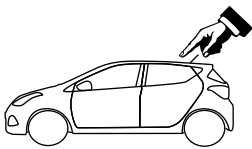

MOCSRR0AC0011 cm 124

MOCSRR0AL0007 cm 124

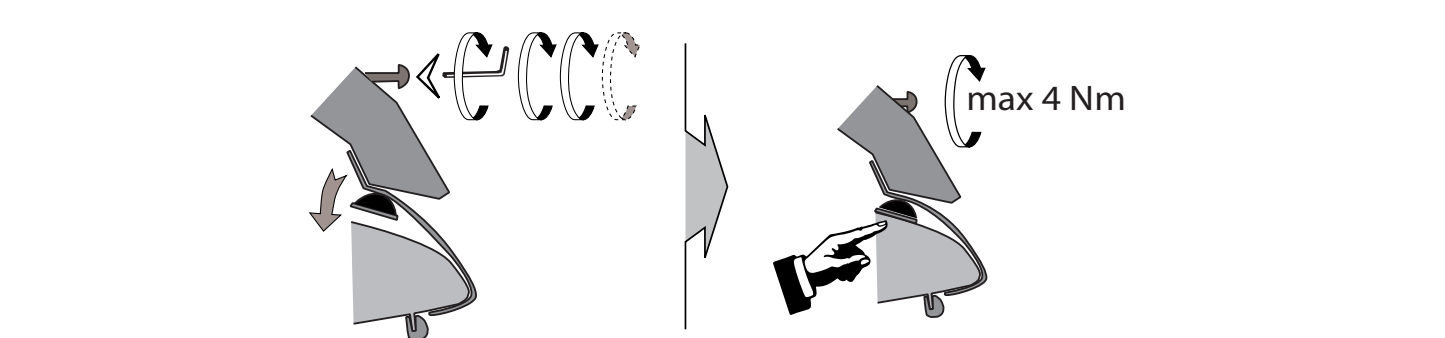
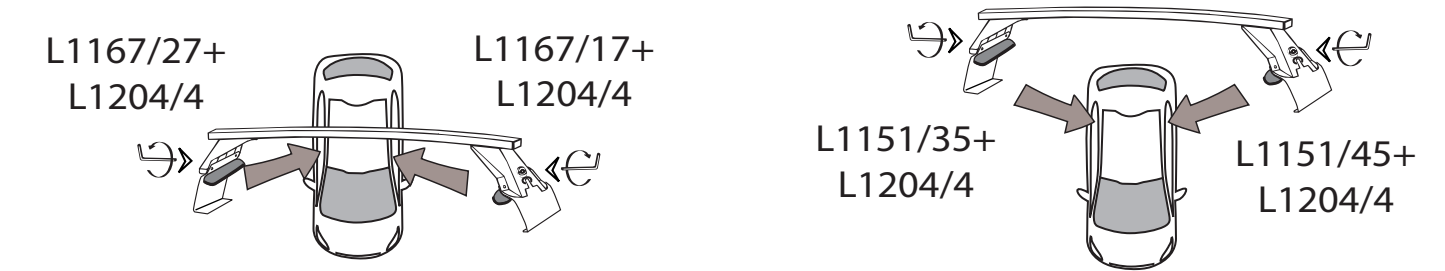
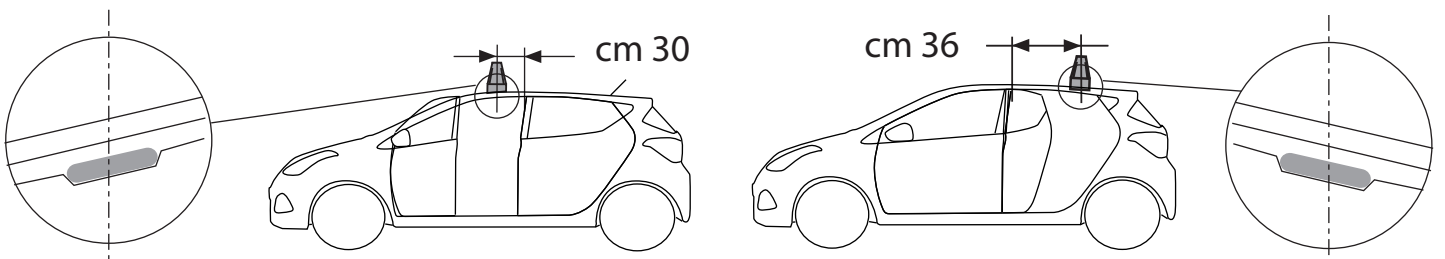
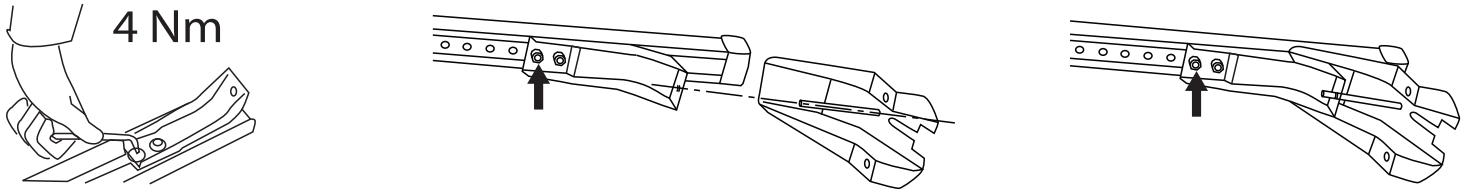
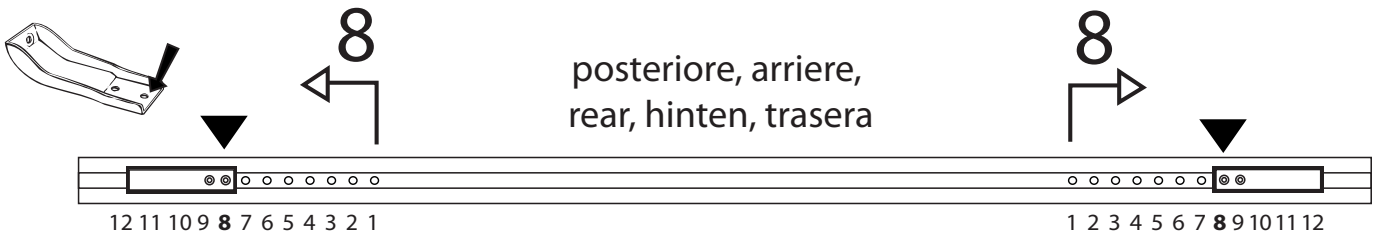

I - Per stringere, usare la chiave come indicato nel disegno. (Non si assumono responsabilità per danni causati dall'impiego di chiavi diverse da quella in dotazione al prodotto).
F - Pour serrer, utiliser la clé comme indique ci dessous.

GB - To tighten please use the wrench as per the drawing.
D - Zum Anziehen benutzen Sie bitte den Inbusschlüssel, nur wie auf dem Bild dargestellt.
E - Para el correcto ajuste, utilizar la llave fija tal y como se indica en la imagen

