

MAZDA 3 2013

MOSKIT 266



MOSRR0AC011 cm 124

MOSRR0AL007 cm 124

1 - L1342/3 ant. sx		1 - L1209/1 post. dx		2 - RC1500/60		4 - RCVM6X13Q	
1 - L1342/4 ant. dx		1 - L1209/2 post. sx		2 - L1204/4		4 - RCVM6X9Q	
		2 - L1297/5		2 - L1058/5		4 - RC20200026	
						1 - RCBR5	

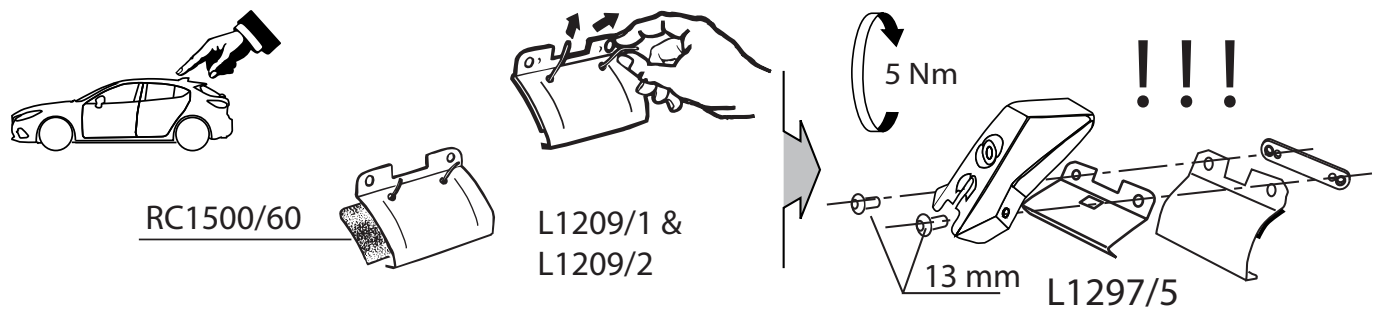
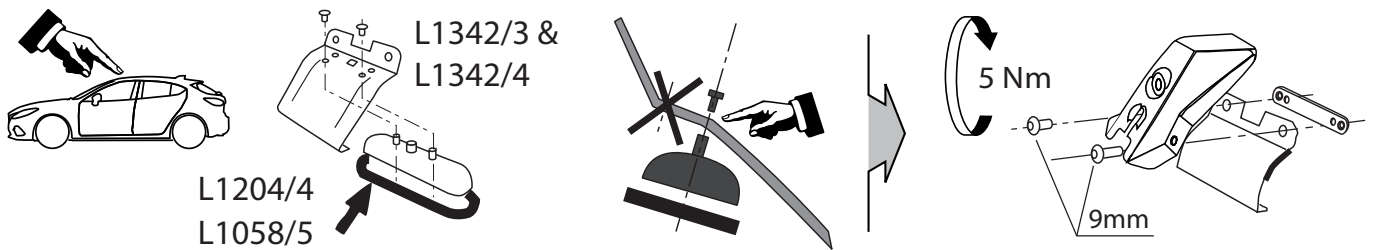

MOSRR0AC011 cm 124 - MOSRR0AL007 cm 124

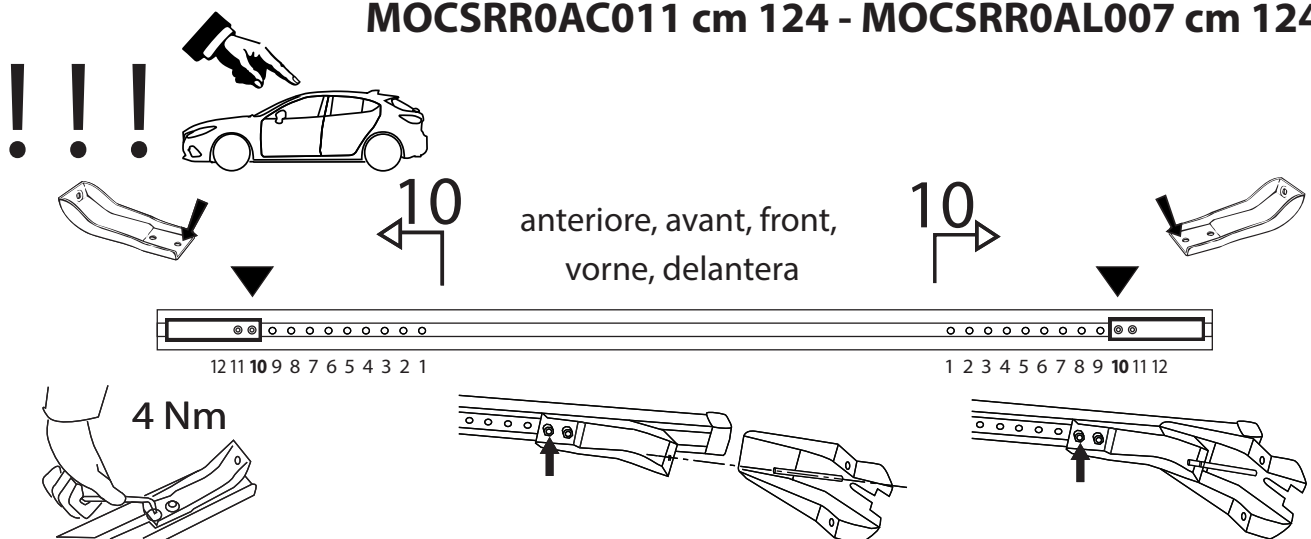

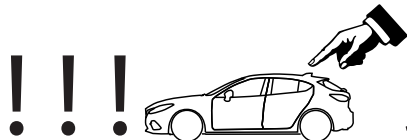

MOCSRR0AC011 cm 124
MOCSRR0AL007 cm 124

MOCSKT 266

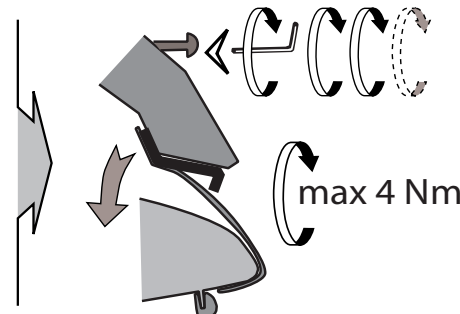
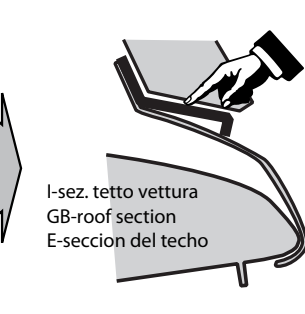
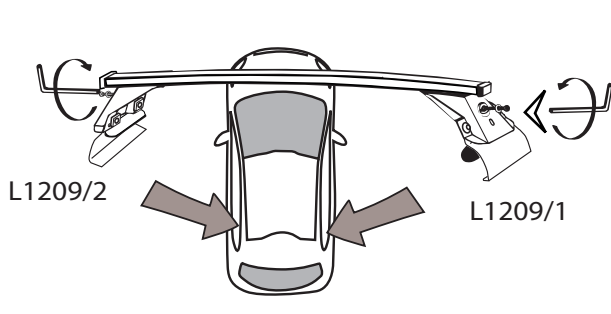
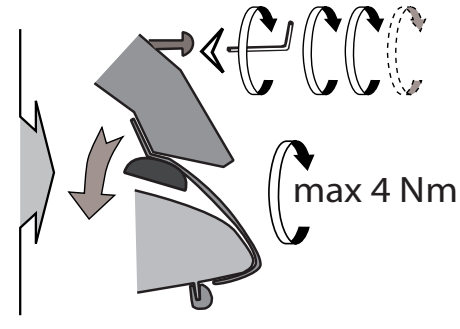
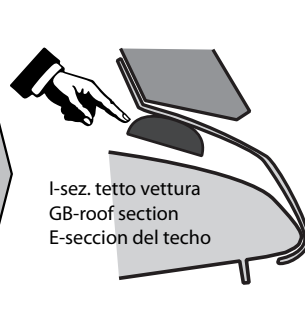
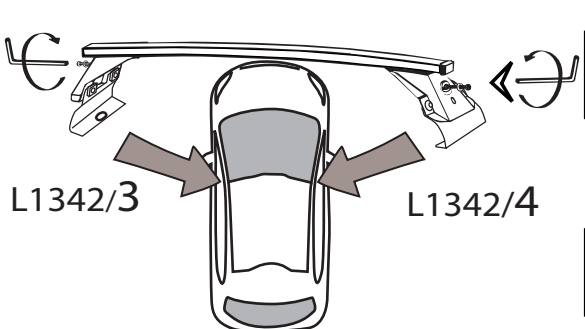
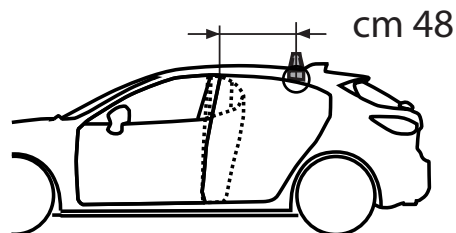
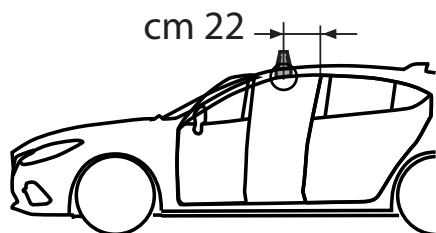
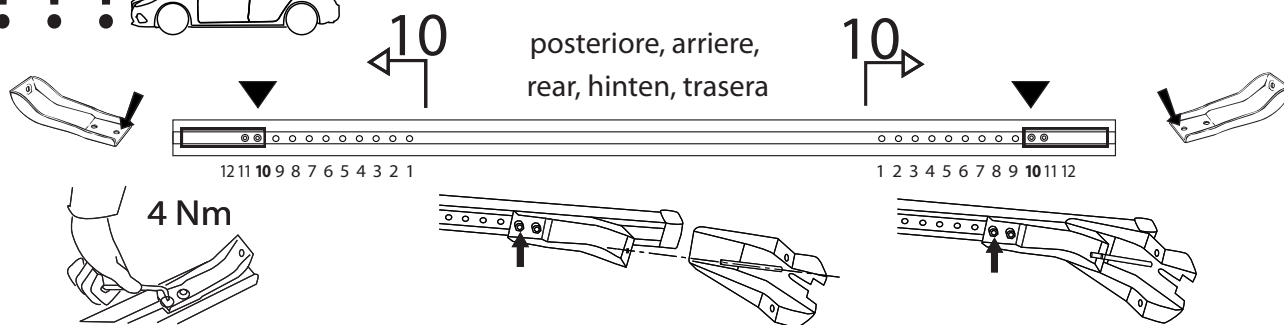

I - Per stringere, usare la chiave come indicato nel disegno. (Non si assumono responsabilità per danni causati dall'impiego di chiavi diverse da quella in dotazione al prodotto).
 F - Pour serrer, utiliser la clé comme indique ci dessous.

GB - To tighten please use the wrench as per the drawing.
 D - Zum Anziehen benutzen Sie bitte den Inbusschlüssel, nur wie auf dem Bild dargestellt.
 E - Para el correcto ajuste, utilizar la llave fija tal y como se indica en la imagen

