

SEAT Leon 5 porte / doors model 2012

Patent pending
MOCSKT 247

MOCSRROAC011 cm 124
MOCSRROAL007 cm 124

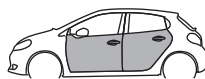

	1 - L1353/2 1 - L1353/1			1 - L1205/35 1 - L1205/45	
2 - L1058/6		2 - RCRD8Q		2 - RC20200026	
2 - RCVM6X16TSQ		2 - RC1500/95		1 - RCBR5	
	16 mm	8 - RCVM6X9Q		1 - RCBR4	

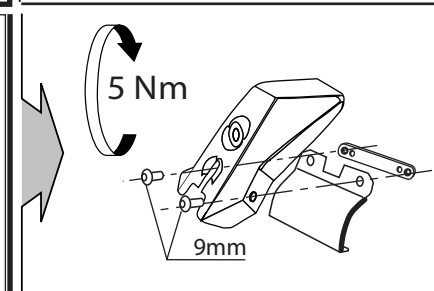
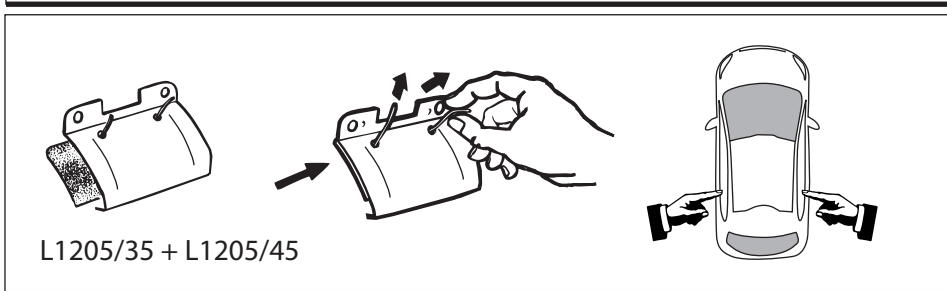
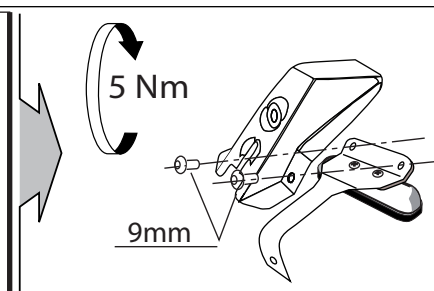
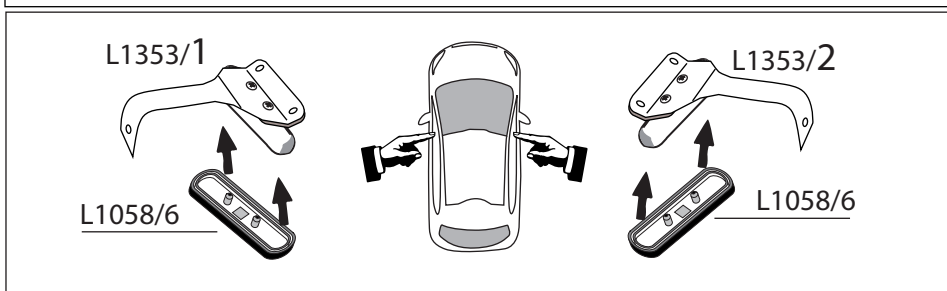

MOCSRROAC011 cm 124 - MOCSRROAL007 cm 124

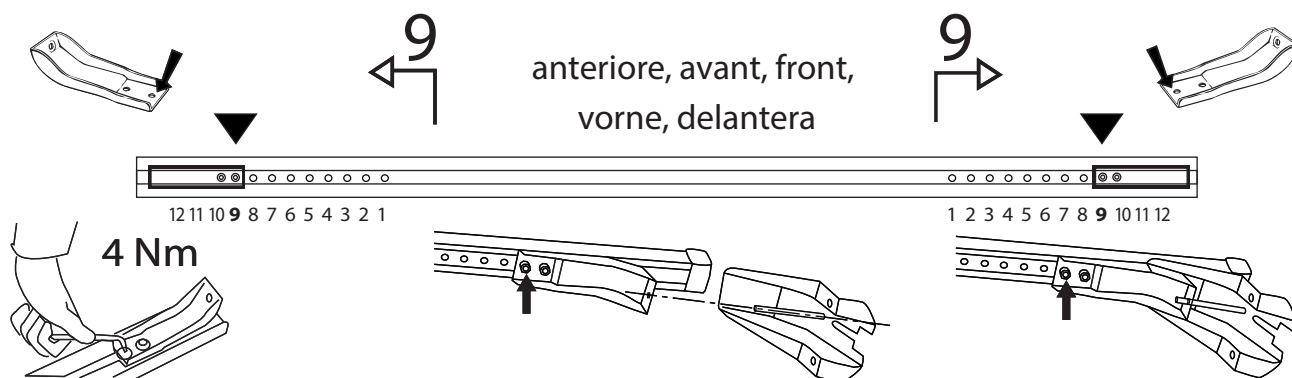



MOCSRROAC011 cm 124
MOCSRROAL007 cm 124

MOCSKT 247

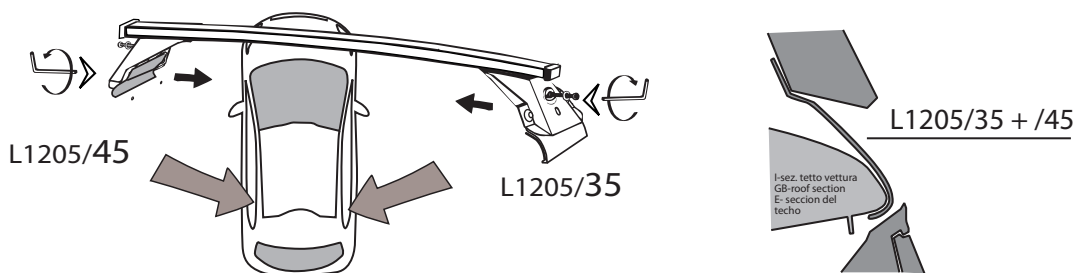
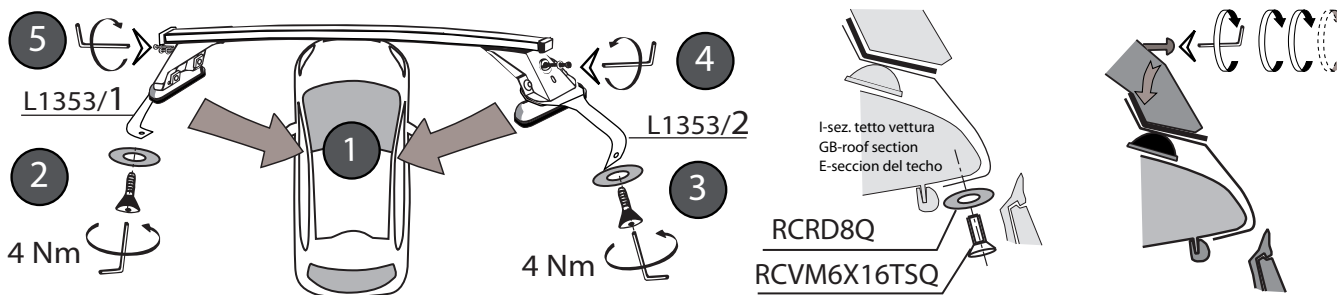
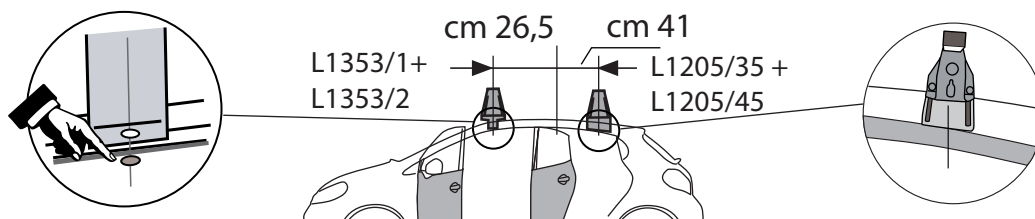
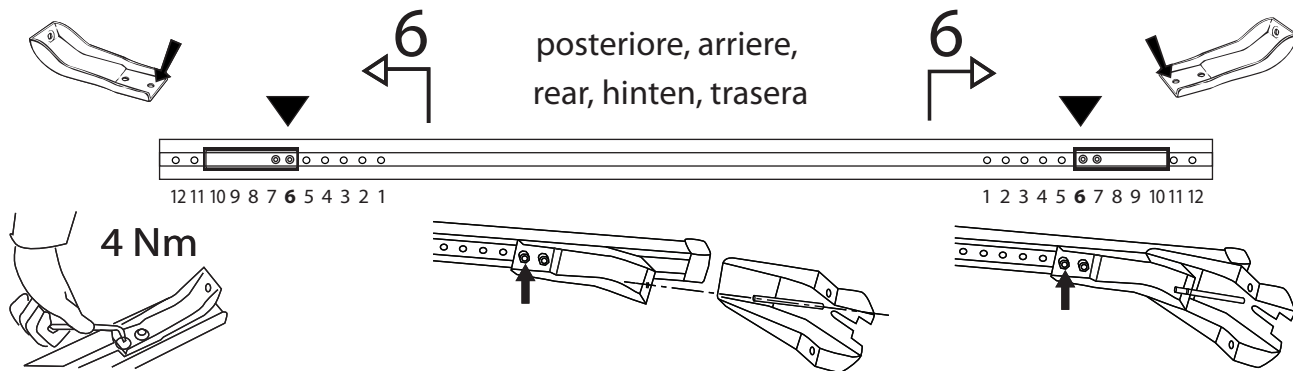

I - Per stringere, usare la chiave come indicato nel disegno. (Non si assumono responsabilità per danni causati dall'impiego di chiavi diverse da quella in dotazione al prodotto).
 F - Pour serrer, utiliser la clé comme indique ci dessous.

GB - To tighten please use the wrench as per the drawing.
 D - Zum Anziehen benutzen Sie bitte den Inbusschlüssel, nur wie auf dem Bild dargestellt.
 E - Para el correcto ajuste, utilizar la llave fija tal y como se indica en la imagen

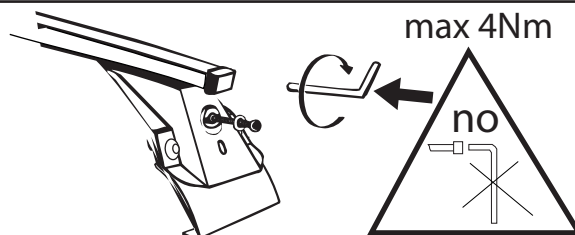

MODULA
 case system

email: modulacs@modulacs.com
 web site: www.modulacs.com

Modula s.r.l.
 Loc. Penisola, 20/A
 61026 Piandimeleto (PU) ITALY
 phone +39 0722/700070
 fax +39 0722/720017

18-01-2016