

KIA Cee'd berlina/sedan 2012
tetto Panorama - sunroof











solo 2 volumi
hatchback only

MOCSKT 227

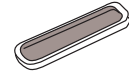
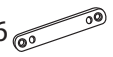

MOCSRROAC011 cm 124
MOCSRROAL007 cm 124

1 - L902/1 ant. sx 	1 - L1125/3 post. dx 	4 - L1204/4 	8 - RCVM6X9Q 
1 - L902/2 ant. dx 	1 - L1125/4 post. sx 	4 - L1058/5 	4 - RC20200026 
			1 - RCBR5 

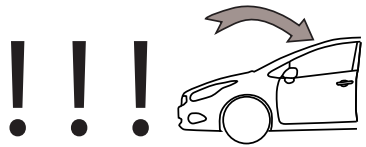
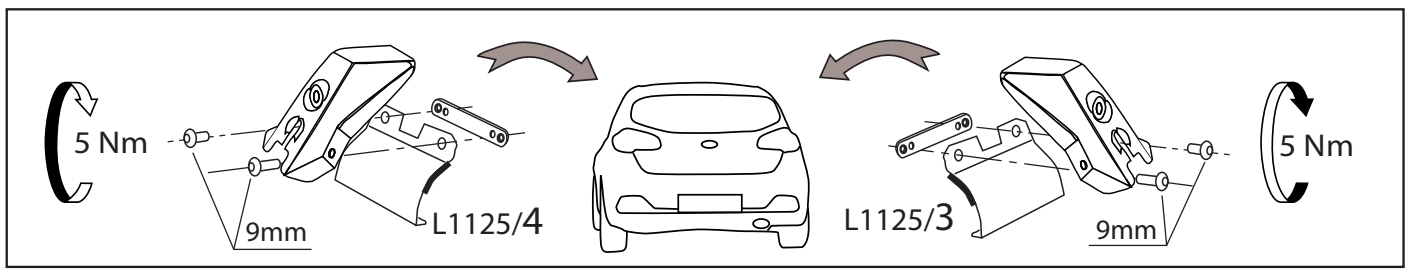
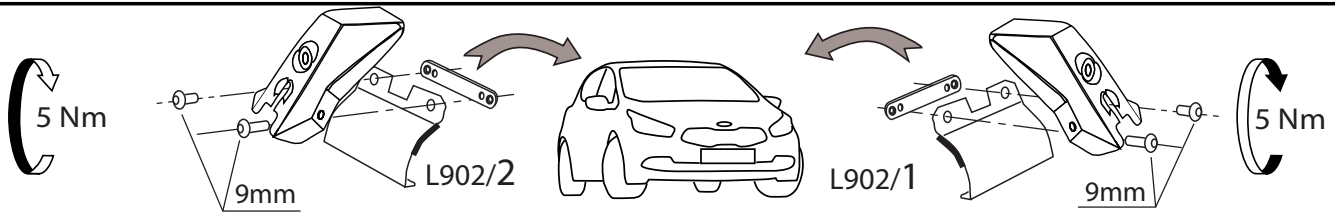
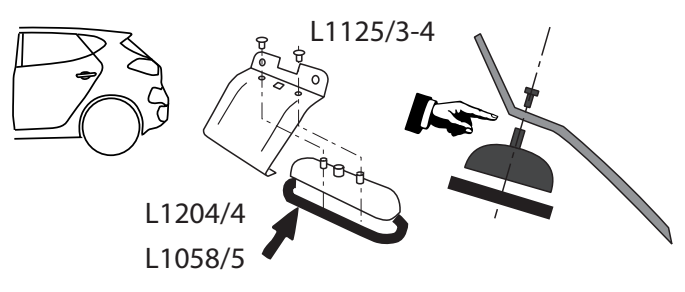
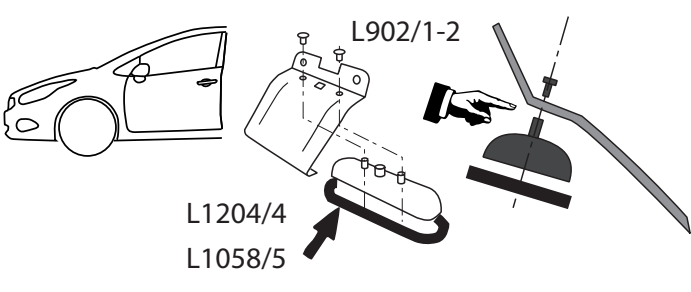

MOCSRROAC011 cm 124
MOCSRROAL007 cm 124

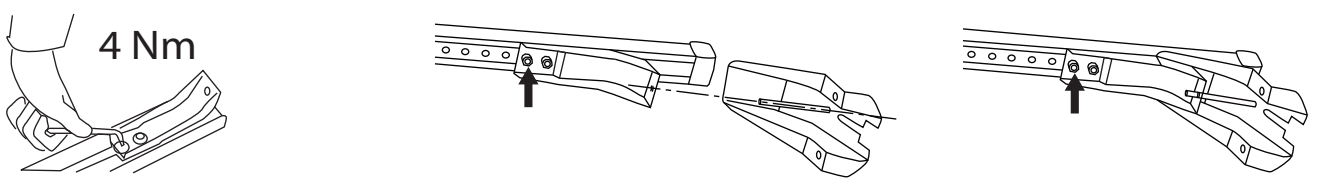
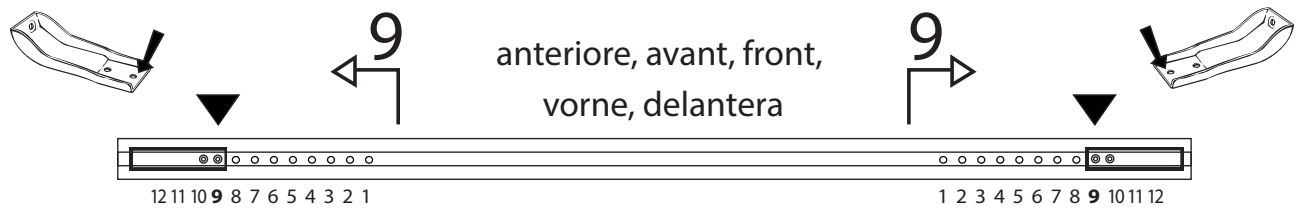

MOCSKT 227

MOCSRR0AC011 cm 124 MOCSRR0AL007 cm 124

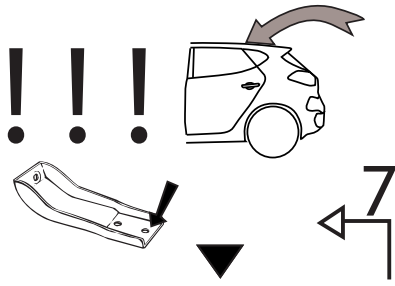

posteriore, arriere,
rear, hinten, trasera

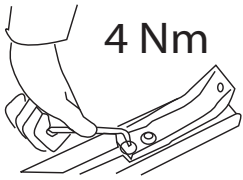
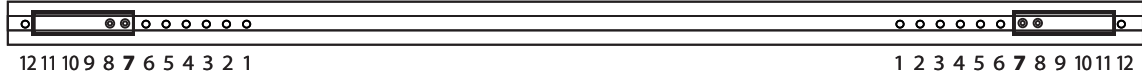
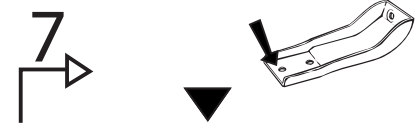

4 Nm

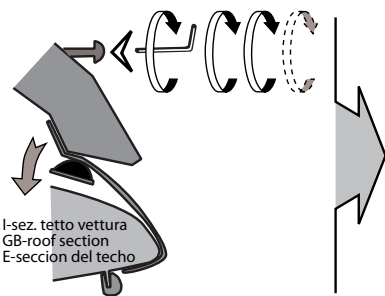
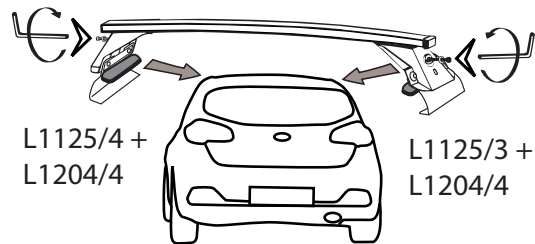
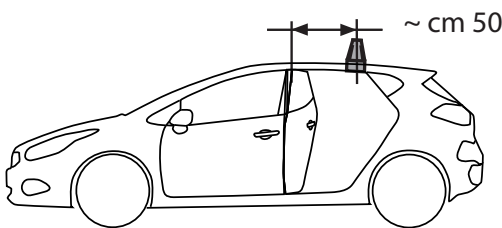
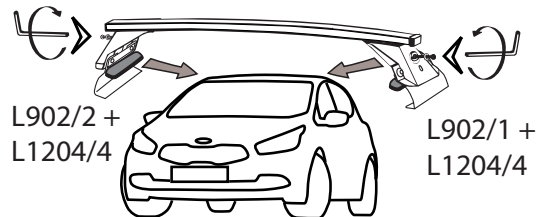
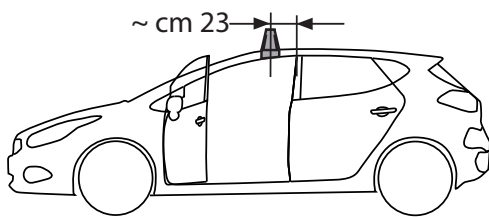
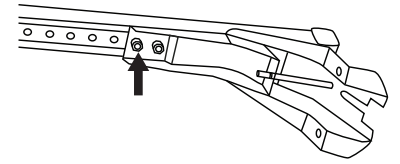
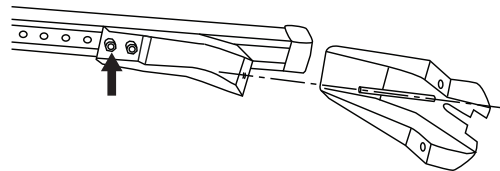

I-sez. tetto vettura
GB-roof section
E-sección del techo



max 4 Nm

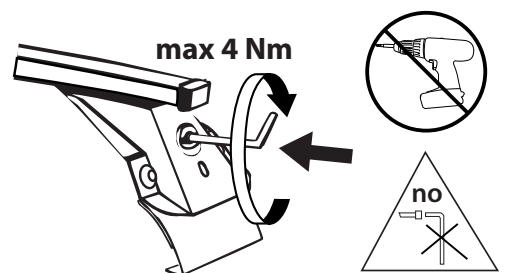

A barre montate non aprire il tetto Panorama
Do not open the sunroof when bars are on

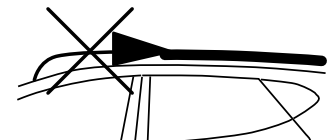

I - Per stringere, usare la chiave come indicato nel disegno.
(Non si assumono responsabilità per danni causati dall'impiego di chiavi diverse da quella in dotazione al prodotto).
F - Pour serrer, utiliser la clé comme indique ci dessous.

GB - To tighten please use the wrench as per the drawing.
D - Zum Anziehen benutzen Sie bitte den Inbusschlüssel, nur wie auf dem Bild dargestellt.
E - Para el correcto ajuste, utilizar la llave fija tal y como se indica en la imagen