

**DR DR1** 5 porte modello 2010

**MOCSKT 194**

**MOCSRROAC010 cm 110**  
**MOCSRROAL006 cm 110**



componenti:

- |                     |  |                     |  |               |  |                |  |
|---------------------|--|---------------------|--|---------------|--|----------------|--|
| 1 - L1032/1 ant. sx |  | 1 - L838/3 post. dx |  | 4 - RC1500/45 |  | 4 - RC20200026 |  |
| 1 - L1032/2 ant. dx |  | 1 - L838/4 post. sx |  | 8 - RCVM6X9Q  |  | 1 - RCBR5      |  |

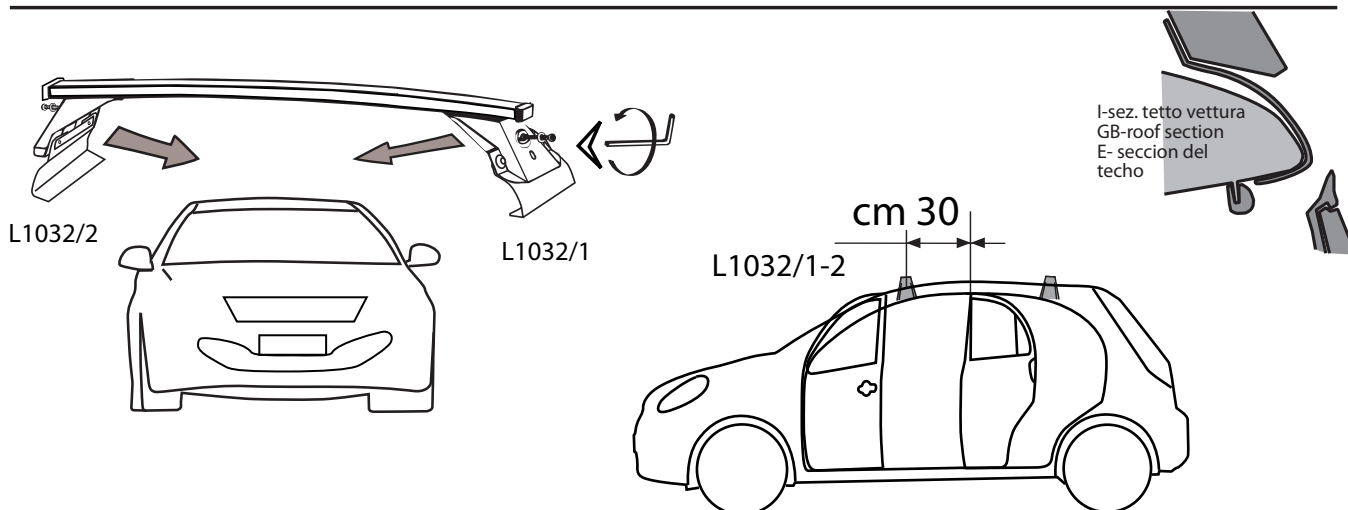
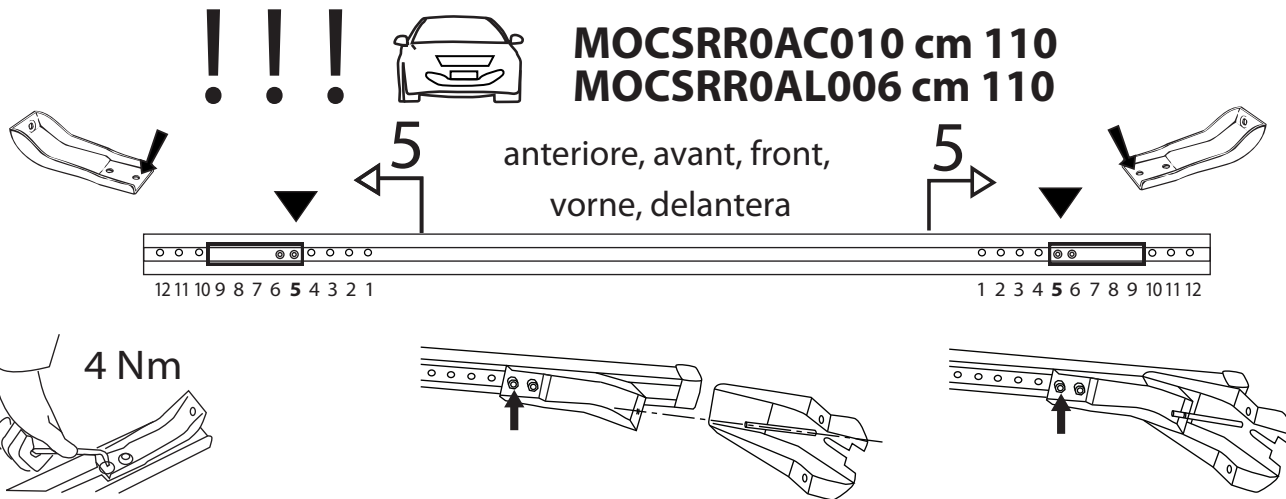
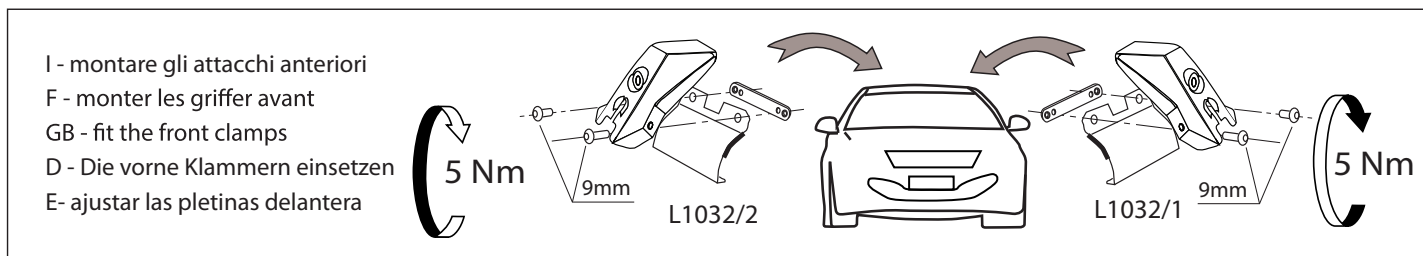

# MOCSKT 194

- I - montare gli attacchi posteriori
- F - monter les griffer arrière
- GB - fit the rear clamps
- D - Die hinten Klammern einsetzen
- E - ajustar las pletinas traseras

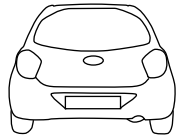
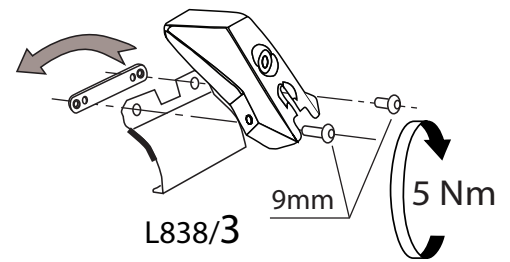
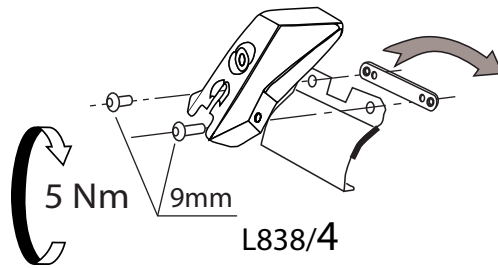

## MOCSRROAC010 cm 110 MOCSRROAL006 cm 110

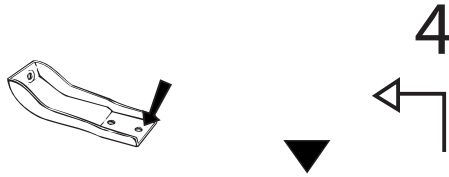

4  
posteriore, arriere,  
rear, hinten, trasera

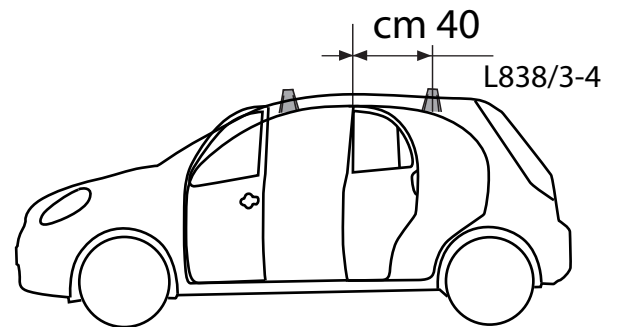
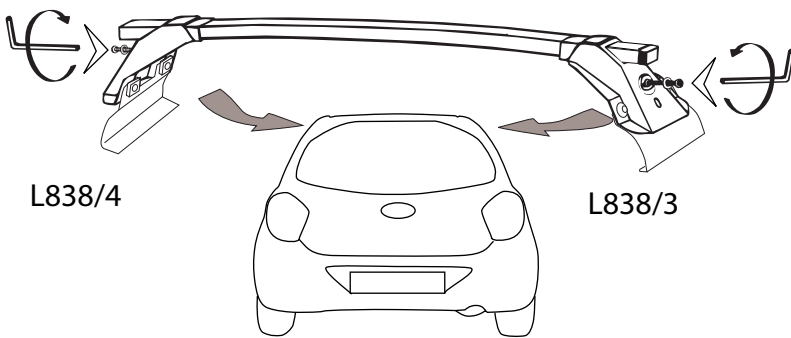
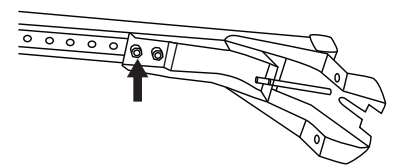
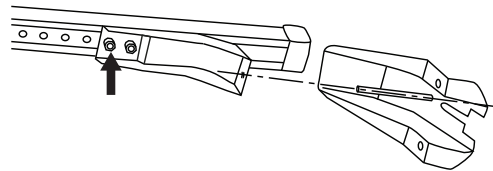
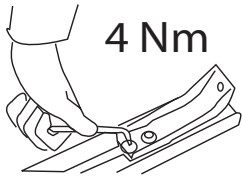
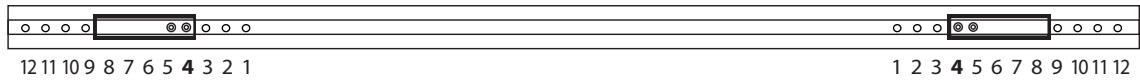
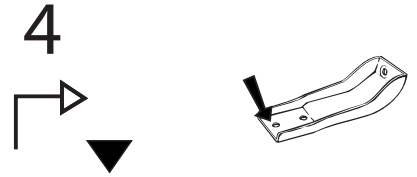

I - Per stringere, usare la chiave come indicato nel disegno. (Non si assumono responsabilità per danni causati dall'impiego di chiavi diverse da quella in dotazione al prodotto).  
F - Pour serrer, utiliser la clé comme indique ci dessous.

GB - To tighten please use the wrench as per the drawing.  
D - Zum Anziehen benutzen Sie bitte den Inbusschlüssel, nur wie auf dem Bild dargestellt.  
E - Para el correcto ajuste, utilizar la llave fija tal y como se indica en la imagen

