

Toyota Hi Ace modello 1996; 2008

MOCSKT 155



MOCSRR0AC011 cm 124

MOCSRR0AL007 cm 124

4 - L1251		4 - L1058/5		4 - RC20200026	
4 - L1204/4		8 - RCVM6X9Q		1 - RCBR5	

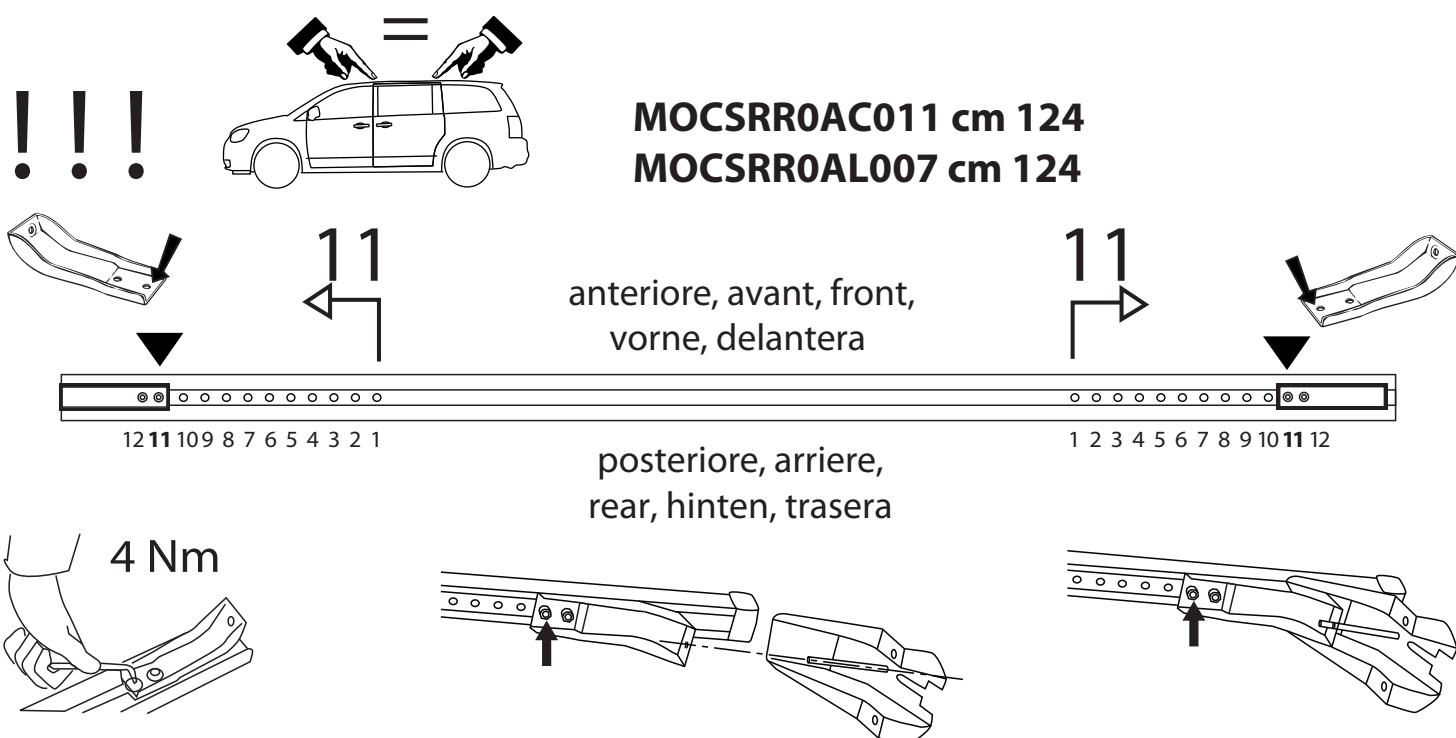
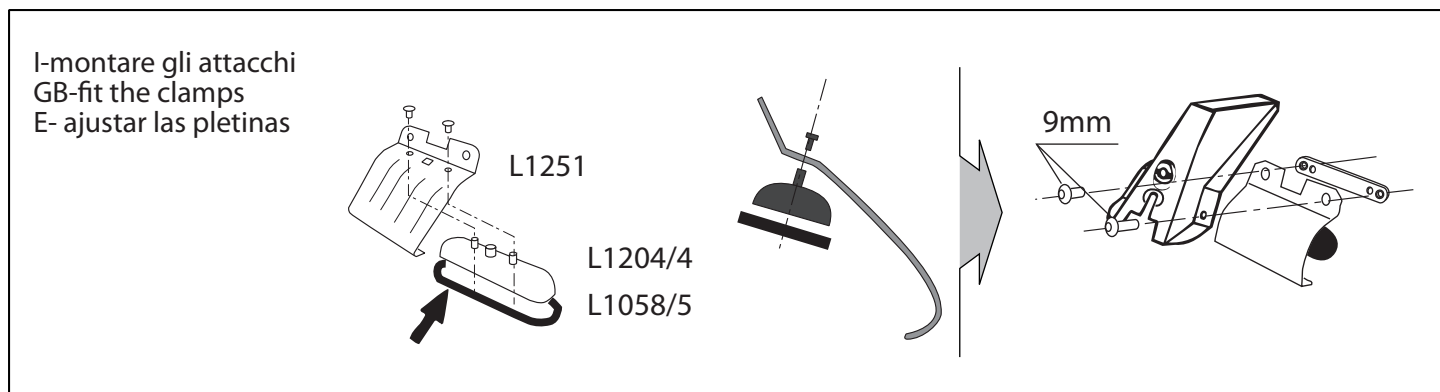

I - montare le barre
 GB - fit the bars
 E - ajustar las barras

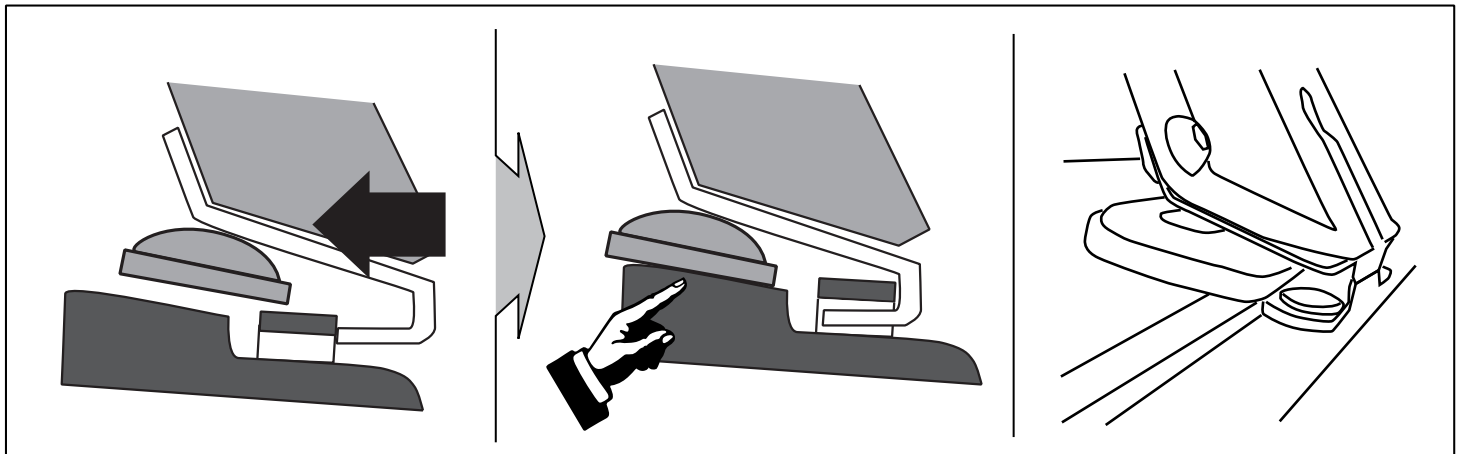
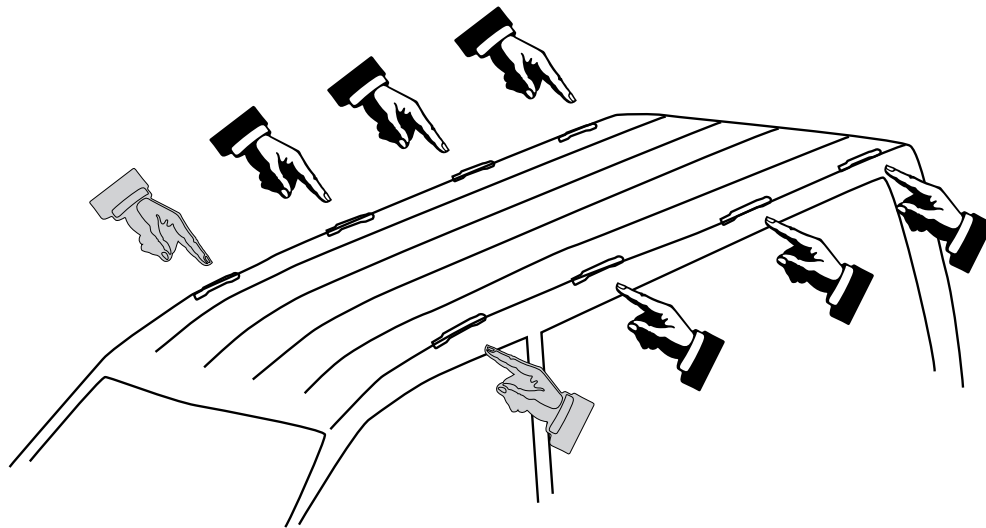
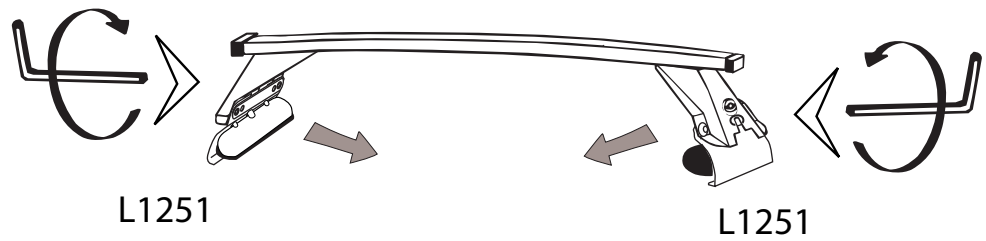

I - Per stringere, usare la chiave come indicato nel disegno. (Non si assumono responsabilità per danni causati dall'impiego di chiavi diverse da quella in dotazione al prodotto).
 F - Pour serrer, utiliser la clé comme indiqué ci dessous.

GB - To tighten please use the wrench as per the drawing.
 D - Zum Anziehen benutzen Sie bitte den Inbusschlüssel, nur wie auf dem Bild dargestellt.
 E - Para el correcto ajuste, utilizar la llave fija tal y como se indica en la imagen

