

**MOCSRR0AC011 cm 124**  
**MOCSRR0AL007 cm 124**

componenti:	1 - L1151/1 ant. sx		4 - RC1500/45			4 - RC20200026	
	1 - L1151/2 ant. dx		4 - RCVM6X9Q		9 mm	4 - RC20011935	
	1 - L1166/1 post dx		4 - RCVM6X16Q		16 mm	2 - RCRD6/20Q	
	1 - L1166/2 post sx		4 - RCVM6X12Q		12 mm	1 - RCBR5	
						1 - RCBR4	

I-montare le guarnizioni  
 F - monter les joints  
 GB - fit the gaskets

D - Die Dichtungen einsetzen  
 E - montar las juntas

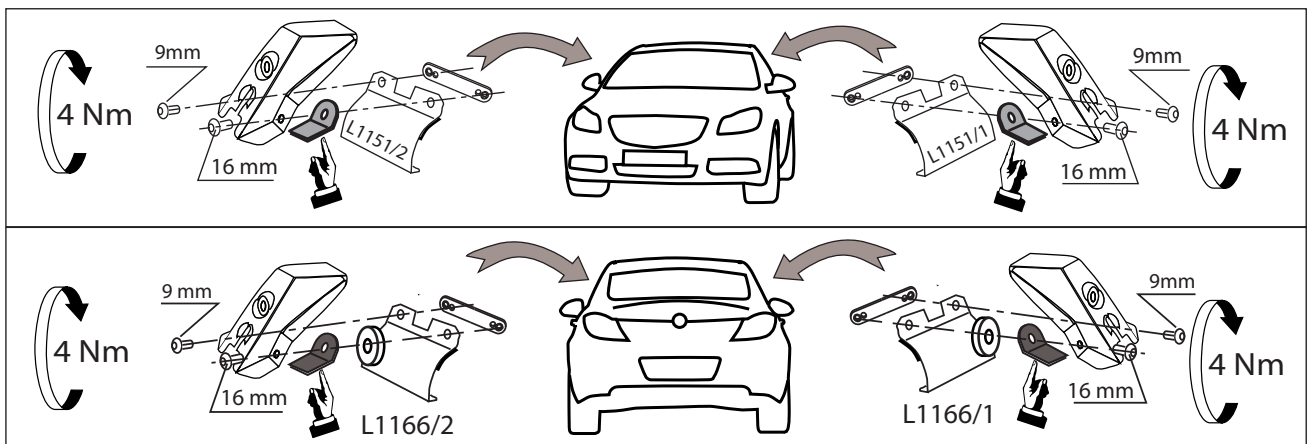
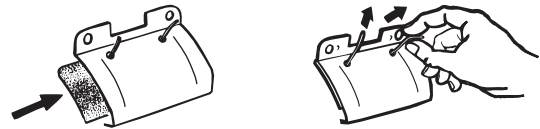

**MOCSRR0AC011 cm 124**  
**MOCSRR0AL007 cm 124**

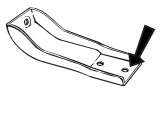

10

anteriore, avant, front,  
 vorne, delantera

10

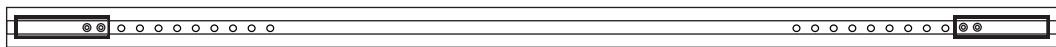
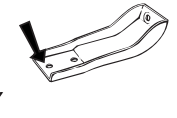

12 11 10 9 8 7 6 5 4 3 2 1

1 2 3 4 5 6 7 8 9 10 11 12

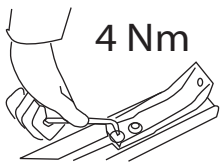

4 Nm

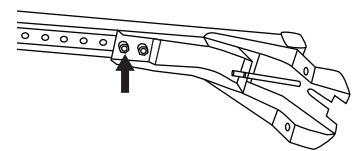
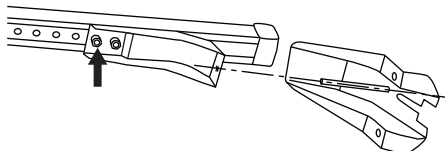

I-montare la barra anteriore.  
 GB- fit the front bar.  
 E- ajustar la barra frontal.

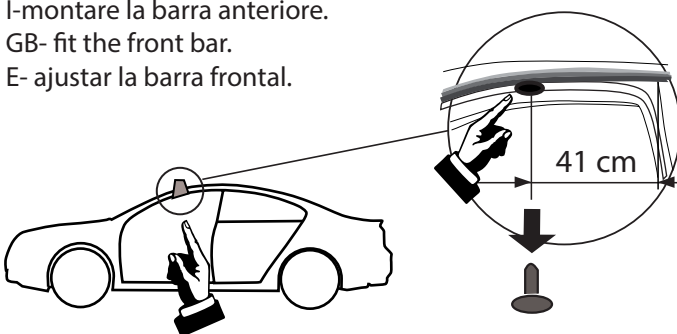

41 cm

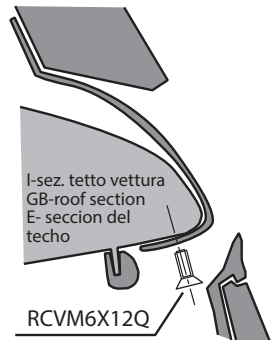
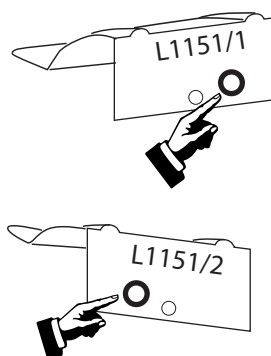

I-sez. tetto vettura  
 GB-roof section  
 E- seccion del techo

RCVM6X12Q

# MOCSKT 129

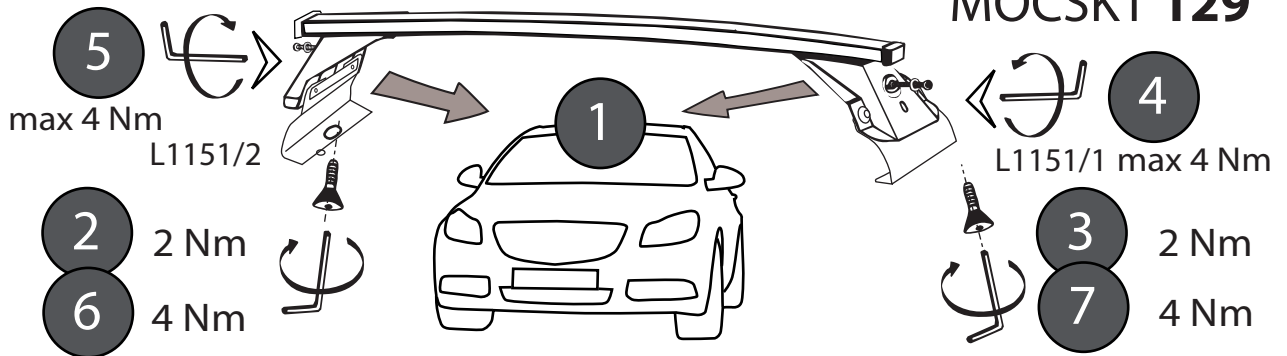

## !!! MOCSRROAC011 cm 124 MOCSRROAL007 cm 124

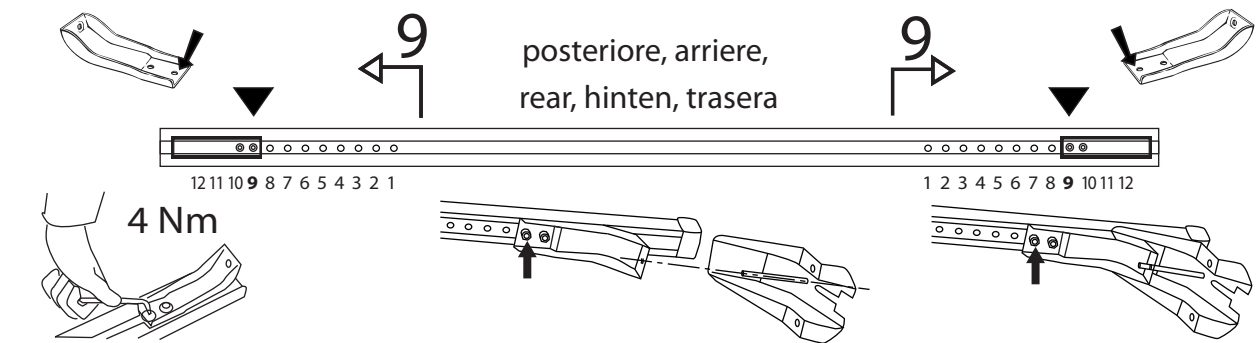

I-montare la barra posteriore  
GB-fit the rear bar  
E- ajustar la barra trasera

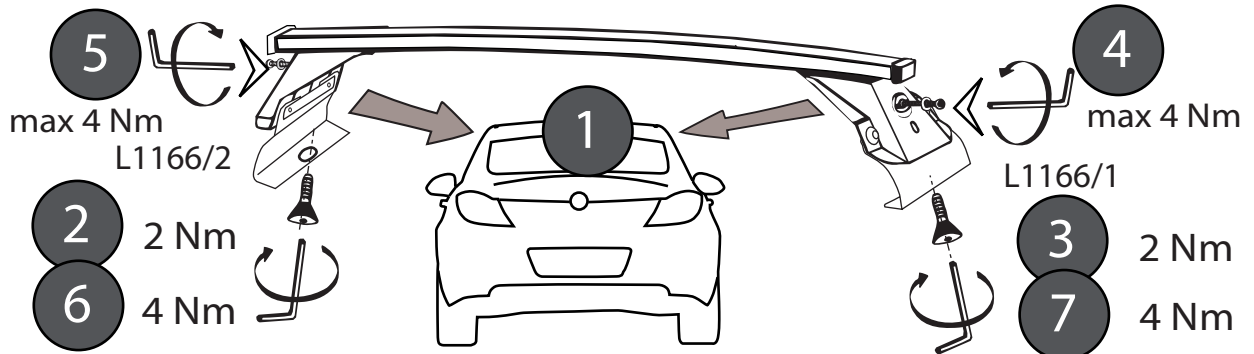
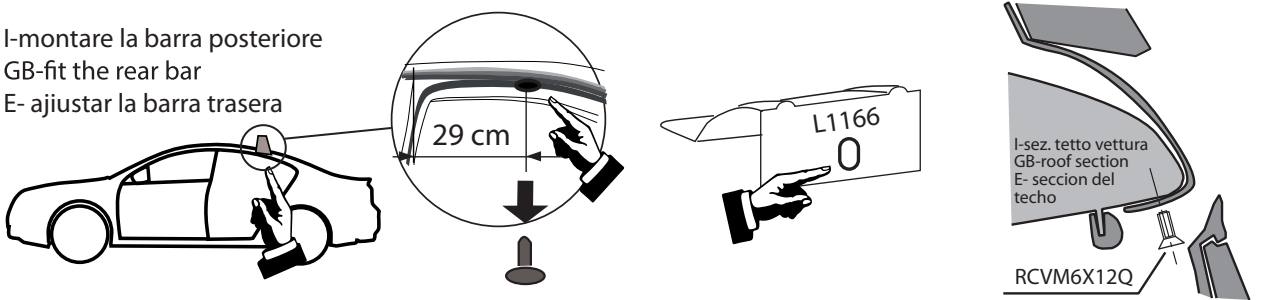

- I Si raccomanda, dopo il montaggio e periodicamente di verificare il fissaggio. La ditta non si assume responsabilità per eventuali danni riportati da persone o cose dovuti al cattivo impiego dei suoi prodotti.
- F On recommande, après le montage et périodiquement de vérifier le fixage. La maison décline toutes responsabilités pour éventuels dommages dus au mauvais emploi de ses produits.
- GB We recommend after assembly and periodically to verify the fixing. The firm dont take responsibility for eventual damages or injury due to the bad use of his products.
- D Es empfiehlt sich, dass ab und zu die richtige Befestigung überwacht werden. Unsere Firma haftet nicht für möglichen Schade zu Persone und Sachen wegen der unfähigen Anwendung unserer Erzeugnisse.
- E Se recomienda verificar la sujeción periódicamente y después de cada montaje. La empresa no se hace responsable de los daños que se puedan ocasionar como consecuencia del mal uso de nuestros productos.

