

TOYOTA HiLux 2006 double cab

MOC SKT 078

MOC SRR0AL007 cm 124

MOC SRR0AC011 cm 124



| | | | | | |
|-------------|--|---------------|--|----------------|--|
| 4 - L753 | | 2 - L1058/5 | | 10 - RCVM6X9Q | |
| 1 - L1206/5 | | 2 - L1204/4 | | 2 - RCVM6X13Q | |
| 1 - L1206/6 | | 2 - RC1500/45 | | 6 - RC20200026 | |
| | | 2 - RCRD6/20Q | | 1 - RCBR5 | |

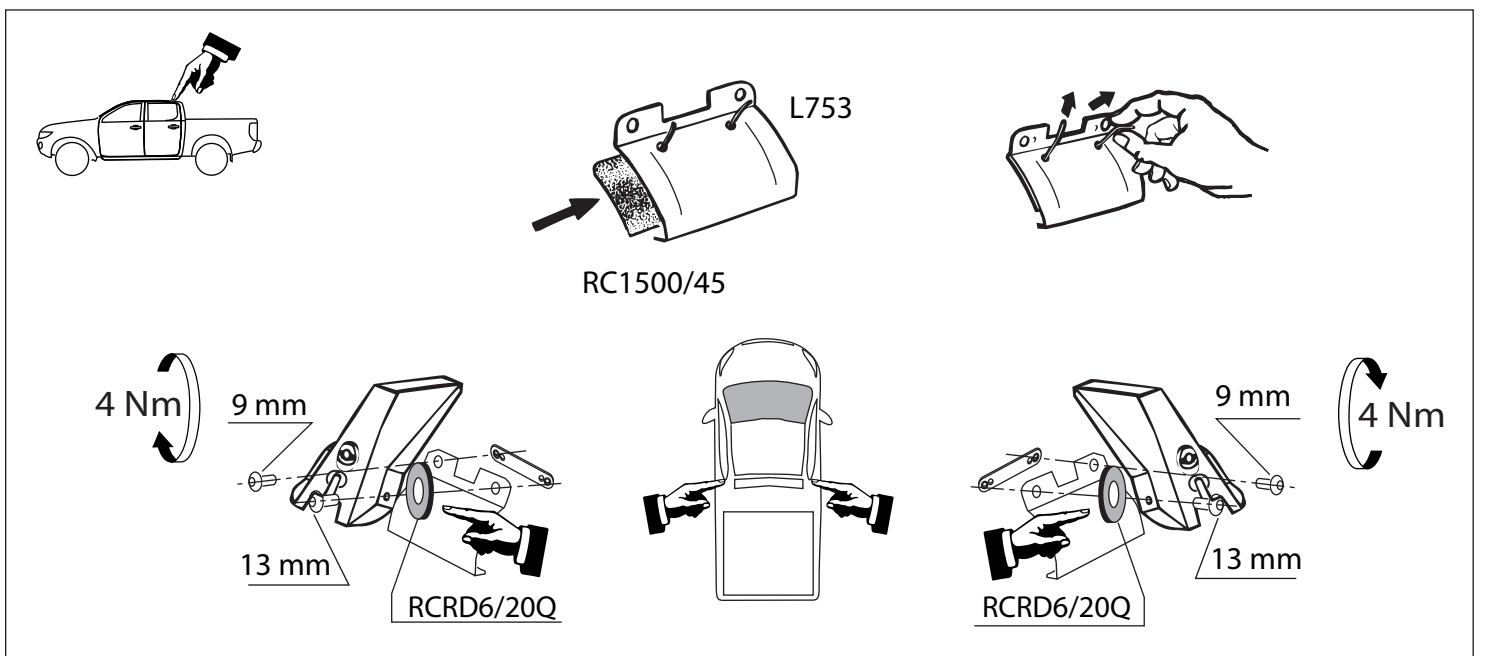
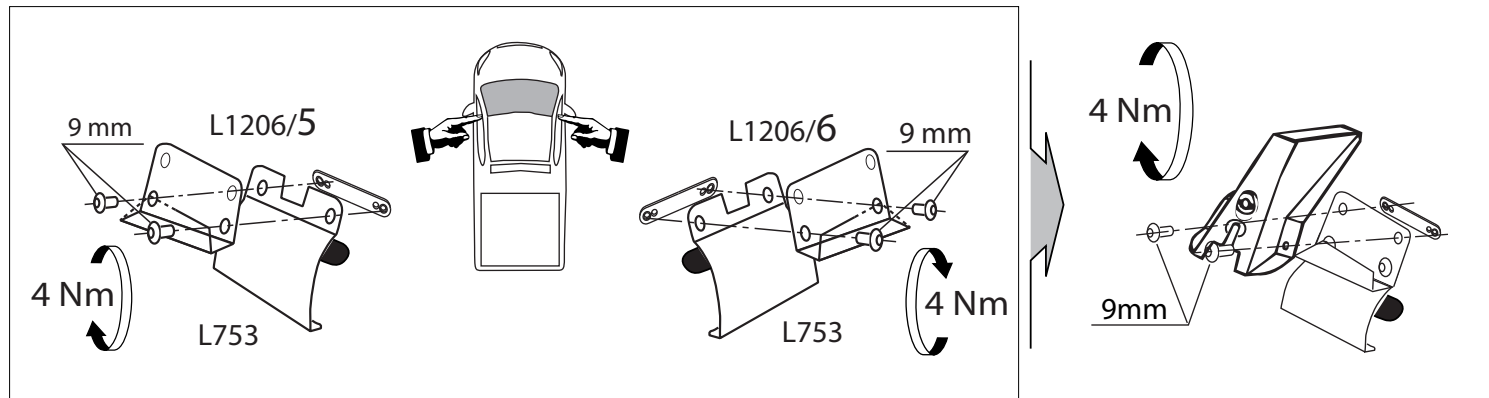
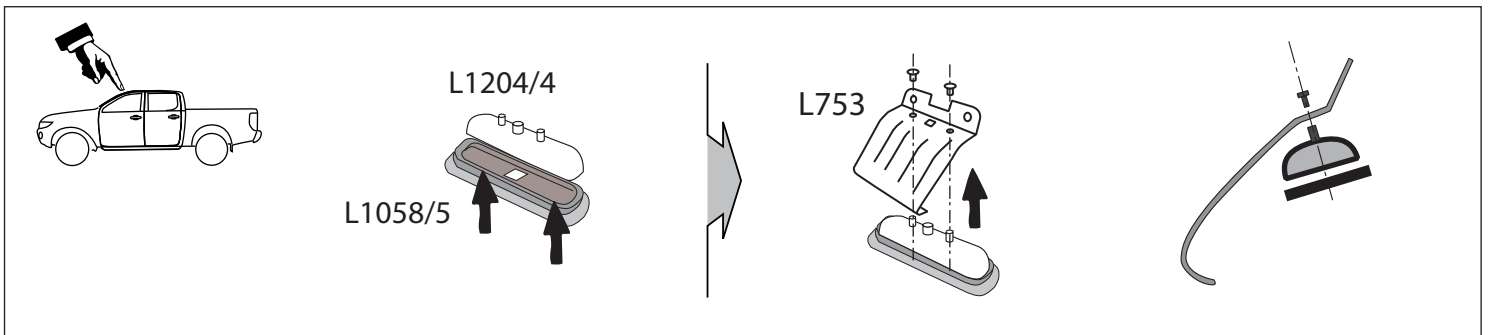

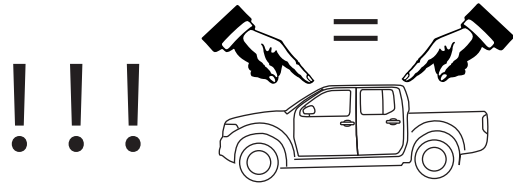

MOCSRR0AC011 cm 124
MOCSRR0AL007 cm 124

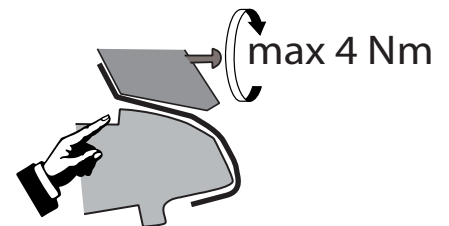
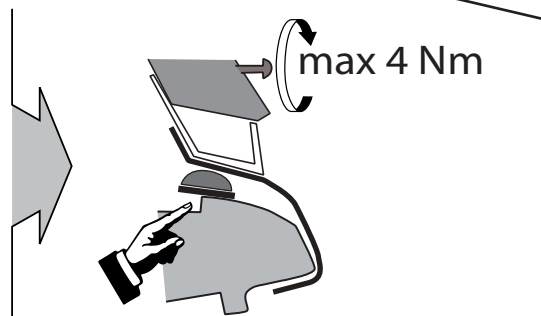
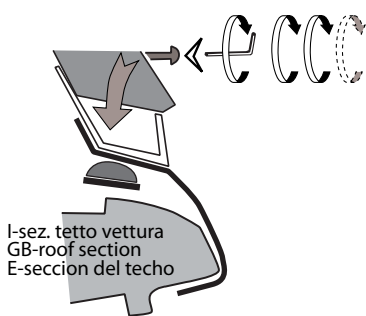
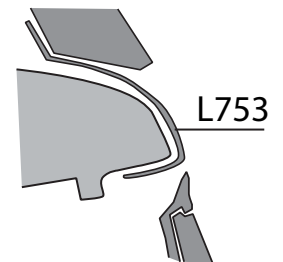
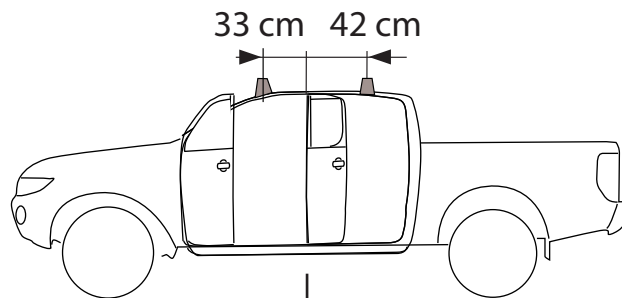
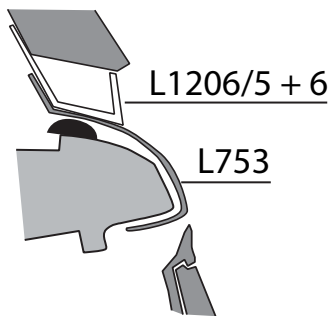
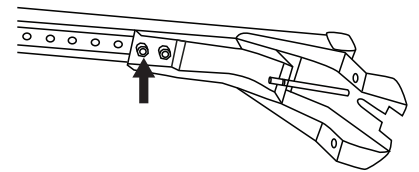
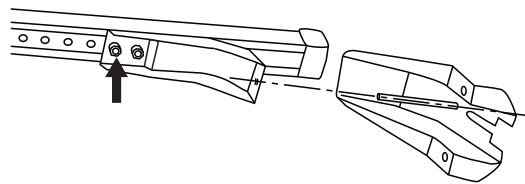
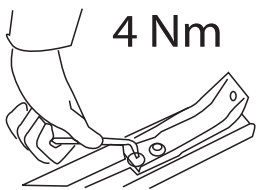
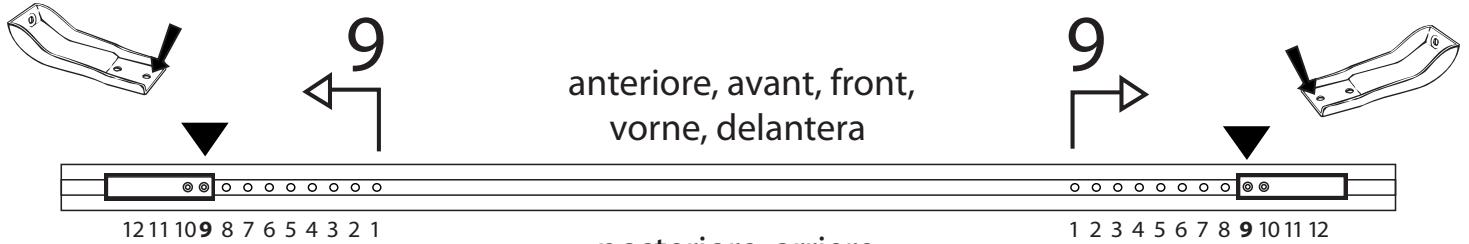

I - Per stringere, usare la chiave come indicato nel disegno. (Non si assumono responsabilità per danni causati dall'impiego di chiavi diverse da quella in dotazione al prodotto).
 F - Pour serrer, utiliser la clé comme indiqué ci dessous.

GB - To tighten please use the wrench as per the drawing.
 D - Zum Anziehen benutzen Sie bitte den Inbusschlüssel, nur wie auf dem Bild dargestellt.
 E - Para el correcto ajuste, utilizar la llave fija tal y como se indica en la imagen

