

Kit 1401

MITSUBISHI L200, 2-dr Crew Cab, 05-09, 10-
MITSUBISHI Triton, 2-dr Crew Cab, 05-09, 10-

480R
754

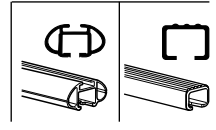
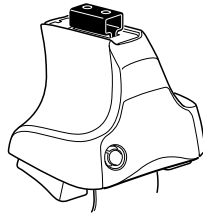

480

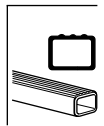
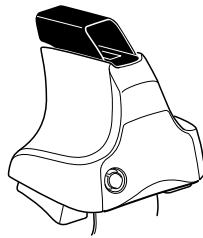

750

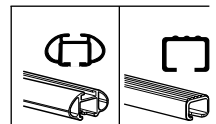
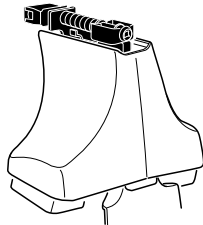

THULE[®]
SWEDEN

Kit

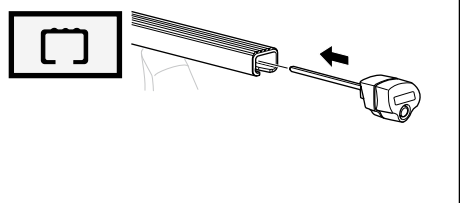
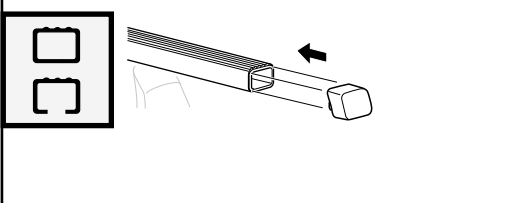
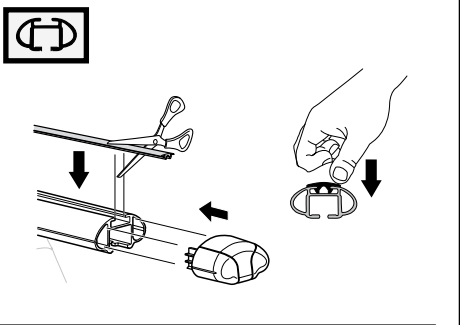
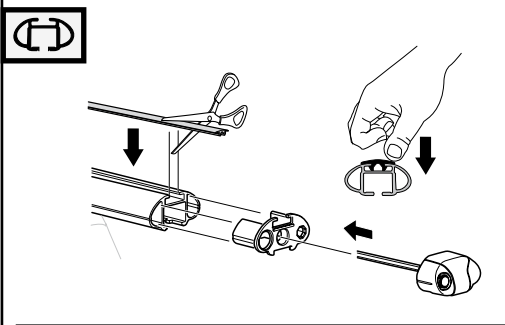
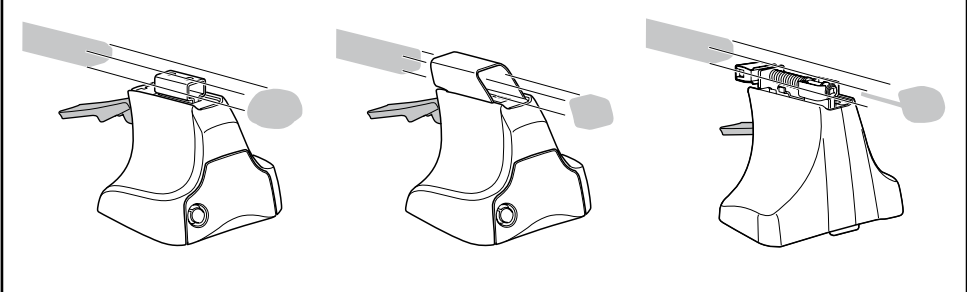
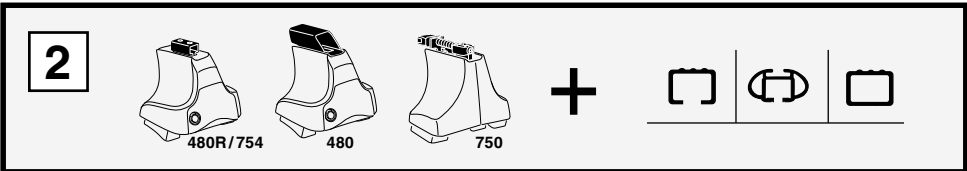
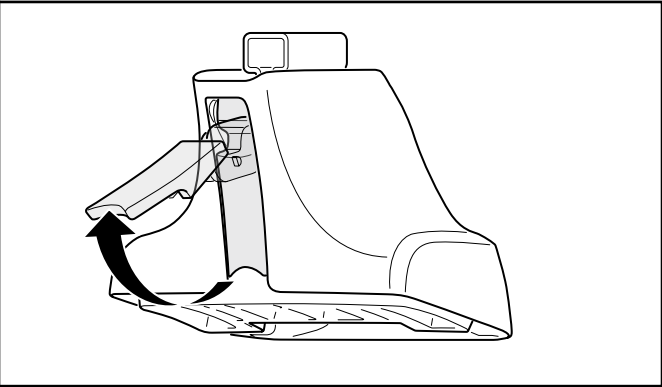
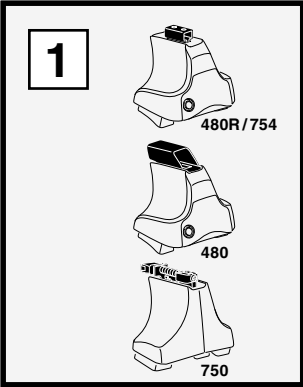

3

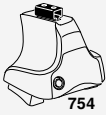

1

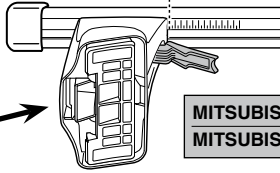
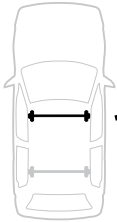

2

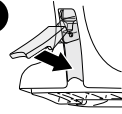

X

| | |
|---|-----------|
| MITSUBISHI L200, 2-dr Crew Cab, 05-09, 10- | 41 |
| MITSUBISHI Triton, 2-dr Crew Cab, 05-09, 10- | 41 |

1

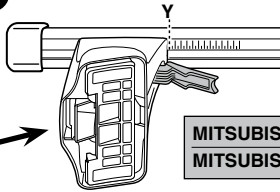

2

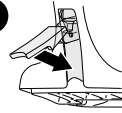

Y

| | |
|---|-------------|
| MITSUBISHI L200, 2-dr Crew Cab, 05-09, 10- | 35,5 |
| MITSUBISHI Triton, 2-dr Crew Cab, 05-09, 10- | 35,5 |



480R



480

1

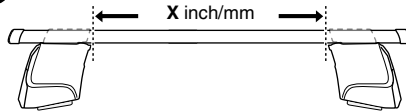
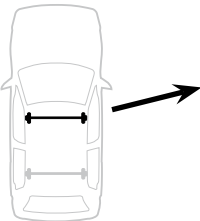

2

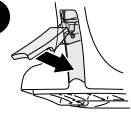

X inch X mm

| | | |
|---|------------------|----------------|
| MITSUBISHI L200, 2-dr Crew Cab, 05-09, 10- | 41 3/4" " | 1061 mm |
| MITSUBISHI Triton, 2-dr Crew Cab, 05-09, 10- | 41 3/4" " | 1061 mm |

1

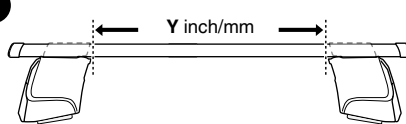
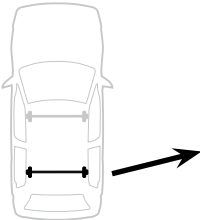

2

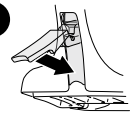

Y inch Y mm

| | | |
|---|------------------|----------------|
| MITSUBISHI L200, 2-dr Crew Cab, 05-09, 10- | 39 5/8" " | 1006 mm |
| MITSUBISHI Triton, 2-dr Crew Cab, 05-09, 10- | 39 5/8" " | 1006 mm |

4

MITSUBISHI L200, 2-dr Crew Cab, 05-09, 10-
 MITSUBISHI Triton, 2-dr Crew Cab, 05-09, 10-

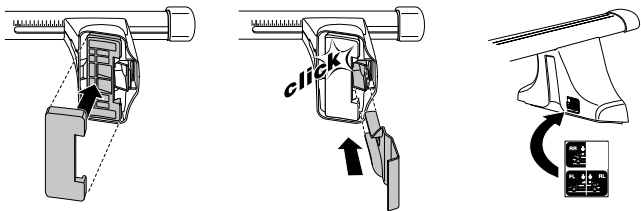
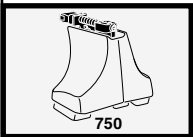
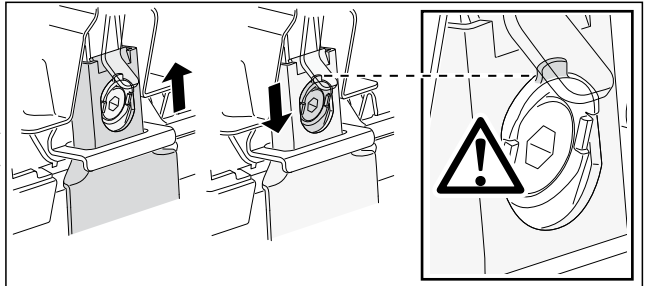
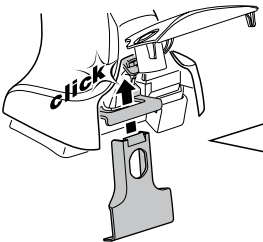
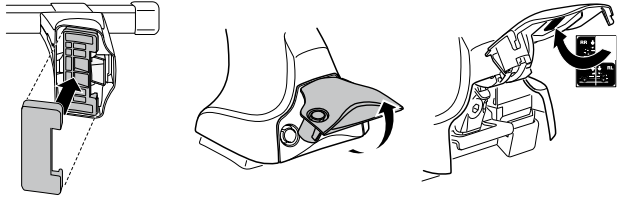
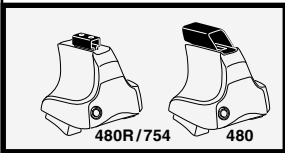
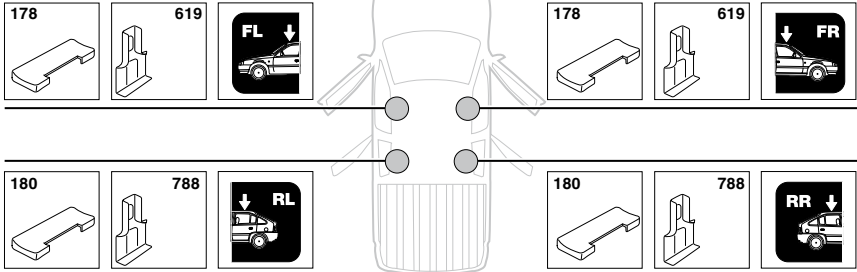

5

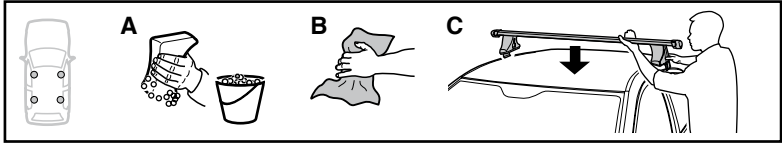

| | X mm | Y mm | X inch | Y inch |
|--|--------|--------|----------------------------------|----------------------------------|
| MITSUBISHI L200, 2-dr Crew Cab, 05-09, 10- | 265 mm | 620 mm | 10 ³ / ₈ " | 24 ³ / ₈ " |
| MITSUBISHI Triton, 2-dr Crew Cab, 05-09, 10- | 265 mm | 620 mm | 10 ³ / ₈ " | 24 ³ / ₈ " |

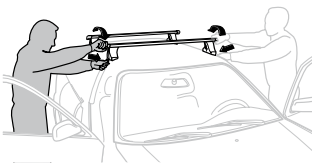
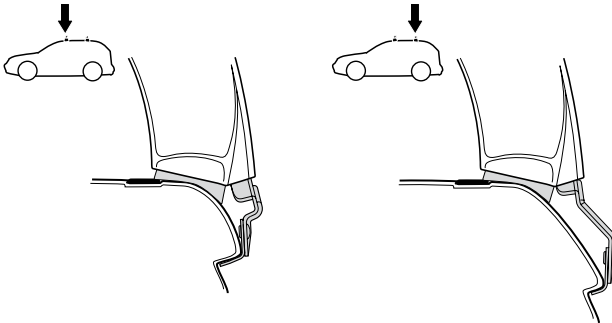
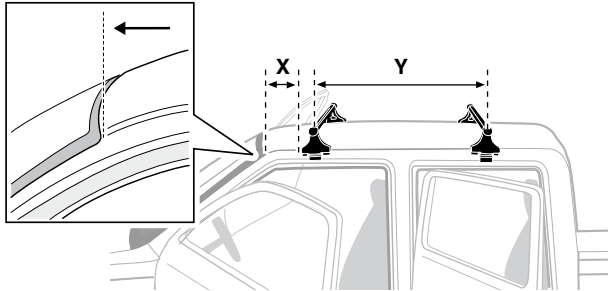

GB/US

Tighten alternately
 D Die Schrauben abwechselnd anziehen
 F Serrer alternativement chaque côté
 NL Afwisselend aan de linker- en de rechterkant aandraaien
 I Alternare il serraggio delle viti
 E Serrare alternativamente
 PT Aperte alternadamente
 S Dra åt växelvis
 FIN Kierrä vuorotellen
 EST Pinguldage vaheldumisi
 LAT Pielvelciēt pamīšus
 LIT Užsukinėkite pakaitomis
 PL Śruby dokręcaj naprzemiennie
 RU Затягивайте попеременно

CZ

Pokręťte багаžníka dokręcaj naprzemiennie.

SK

Dofahujte striedavo

SLO

Privijajte izmenično.

HR

Naizmjenično zategnite

HU

Egymástól függetlenül szorítandó

GR

Σφιγγετε εναλλάξ

TR

Dönüştürümlü sıkın

中文

交替拧紧

한국어

변갈아 가며 조이십시오.

日本語

交互に締め付けてください。

ไทย

ขันในแบบสลับ

6



480R/754



480

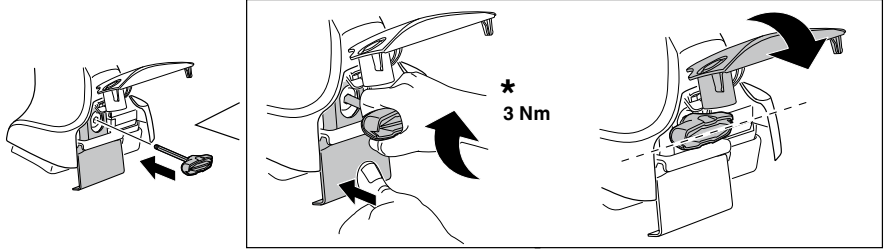

*
3 Nm

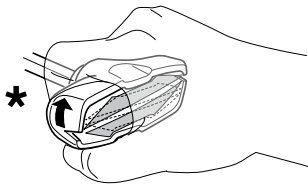

*

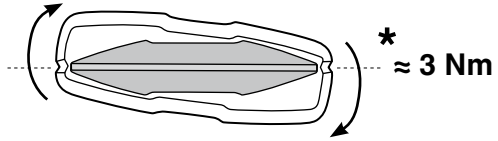

*
≈ 3 Nm

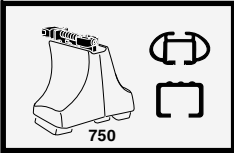
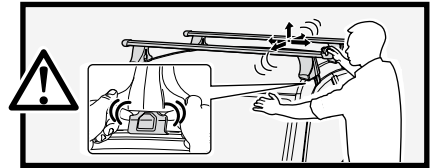

750

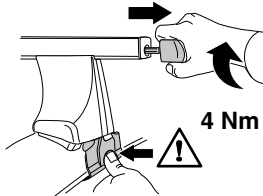

4 Nm

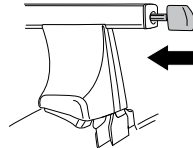

7



x1
17 mm

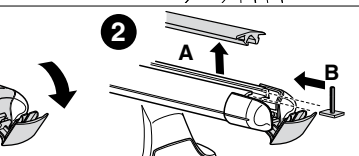
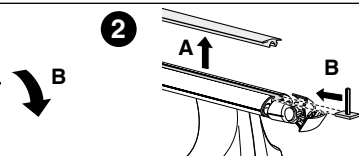
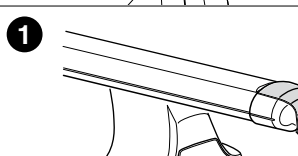
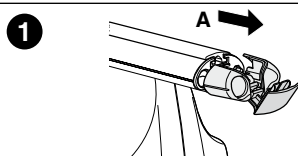
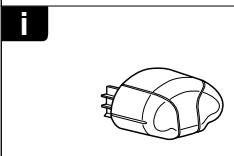
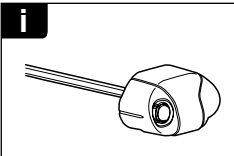
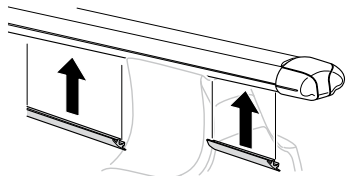

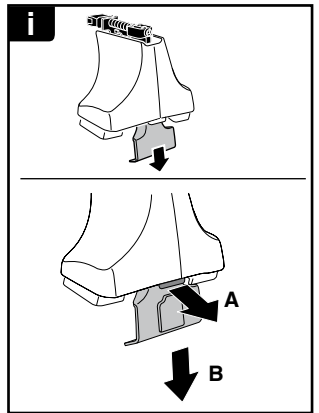
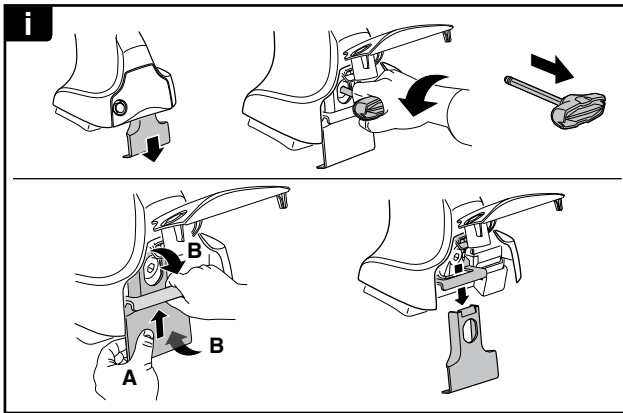
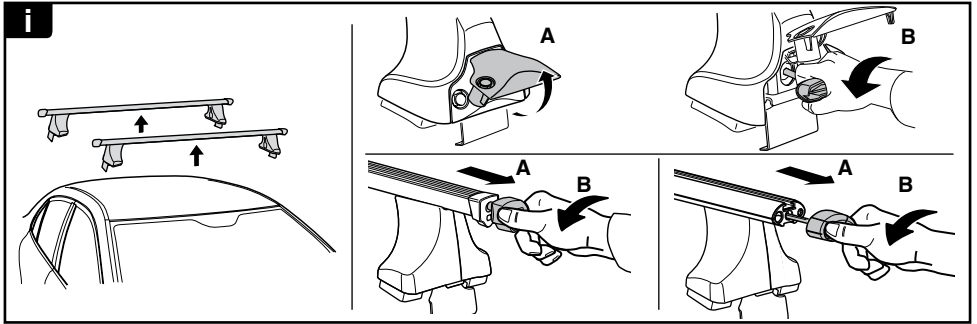

THULE
SWEDEN
**ONE
KEY
SYSTEM**



- 544 (x4)
- 596 (x6)
- 588 (x8)
- NA 510 (x10)
- EUR 452 (x12)
- ASIA



WW ▶ Thule Sweden AB, Box 69, 330 33 Hillerstorp, SWEDEN
NA ▶ Thule Inc., 42 Silvermine Road, Seymour, Connecticut 06483, USA

info@thule.com
customer.service@thule.com

www.thule.com



www.thuleprofessional.com



customer.service@thule.com



info@thule.com



Thule Inc., 42 Silvermine Road, Seymour, Connecticut 06483, USA

Thule Sweden AB, Box 69, 330 33 Hillerstorp, SWEDEN

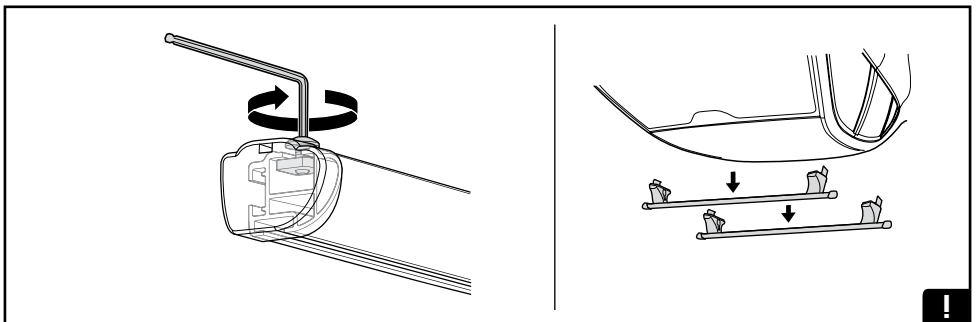
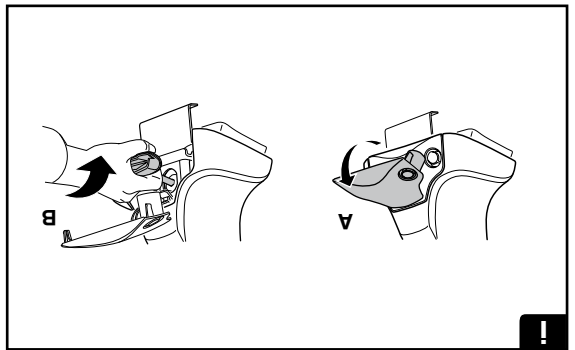
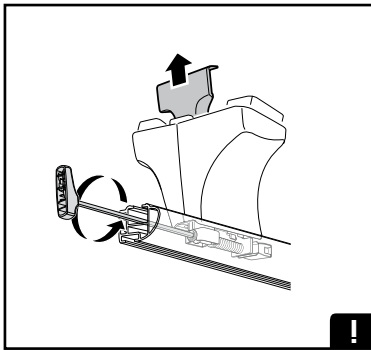
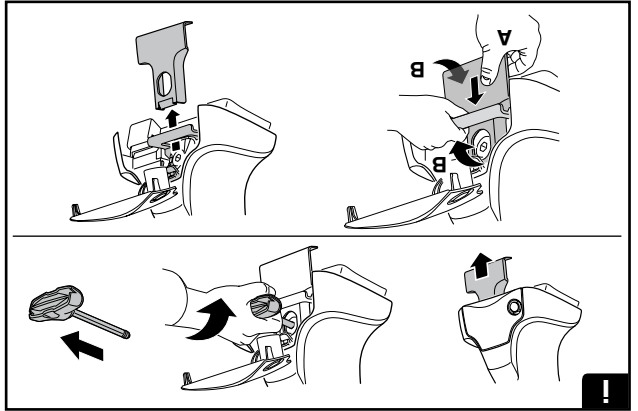
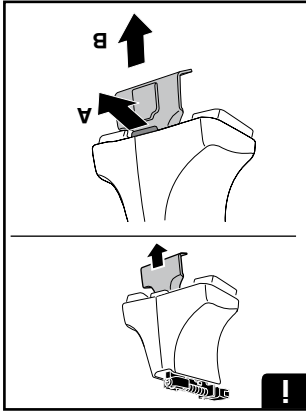

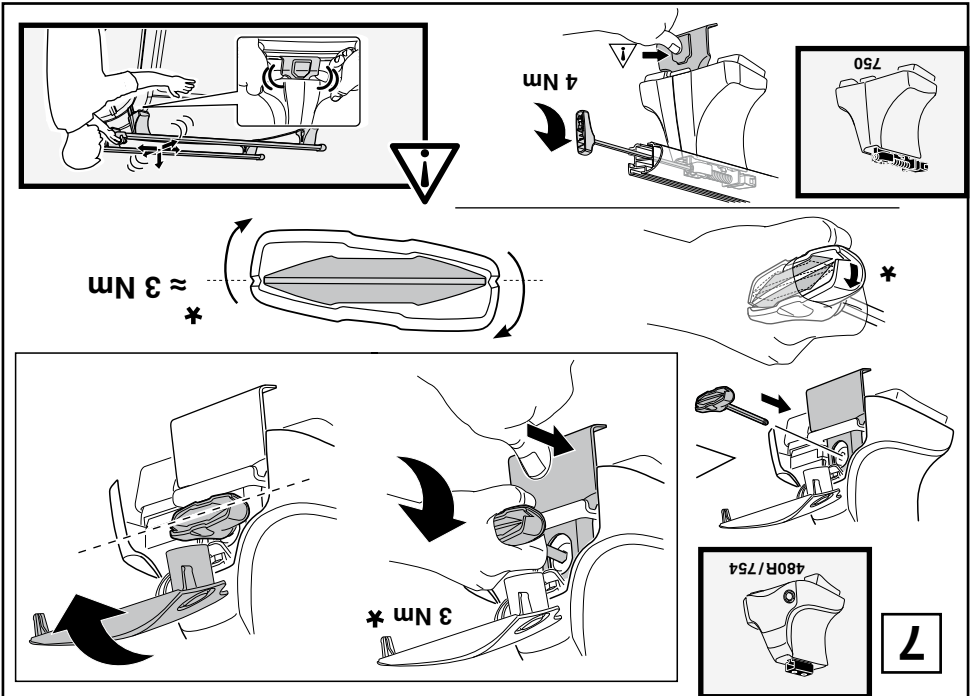
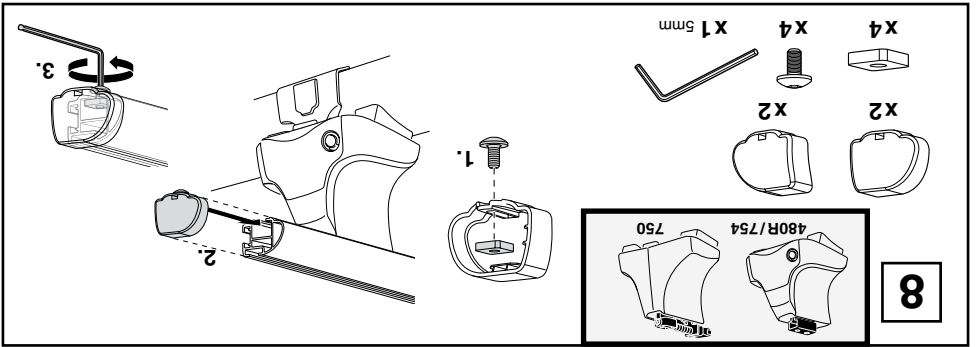
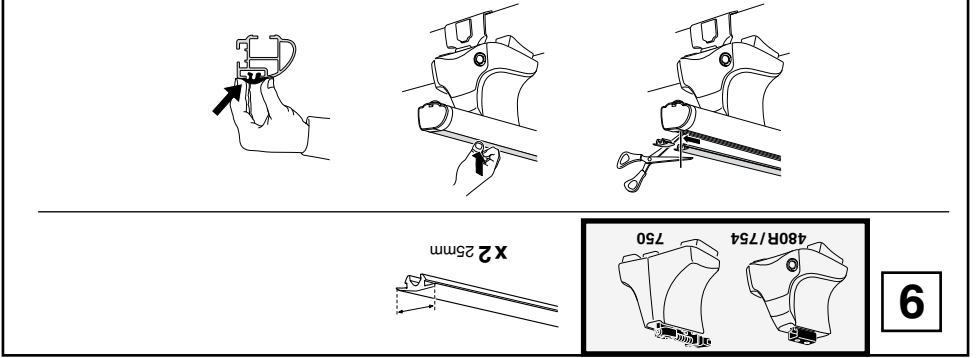

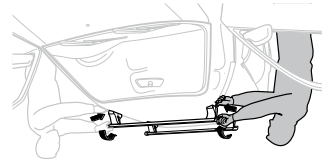

GB/US Tighten alternately
 D Die Schrauben abwechselnd
 F anziehen
 NL Serrer alternatiëvement
 I Alternare il serraggio delle viti
 E Serrare alternativamente
 PT Aperte alternadamente
 S Dra tàt vàxelvis
 FIN Kierrà vuorotellen
 EST Pinguldage vaheldumisi
 LAT Pielietiet pamúsus
 LIT Uzskinkúte pakàtomis
 PL Sztyby dokécaj naprzemiennie
 RU Затягивайте попеременно

CZ Pokréta bagazn&icaron;ka dokécaj
 SK Dotàhuje stredàvo
 SLO dokécaj naprzemiennie.
 HR Privatúje izméniúno.
 HU Nàrméniúcho zàtànúte
 Egvàztàsiú fúggéténtúl
 GR Σúfúvérté evàvàúúú
 TR Dònuúmlúu s&icaron;kn
 中文 交替拧紧
 한국어 번갈아가며 조이십시오.
 日本語 交互に締め付けてください。
 ភ្នំពេញ

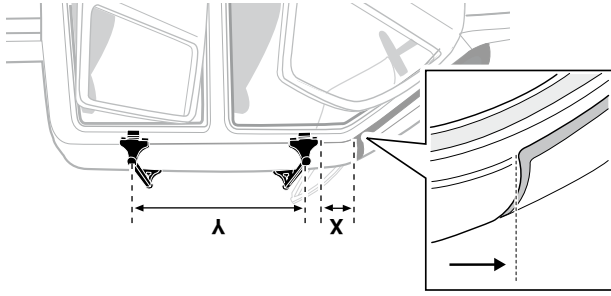
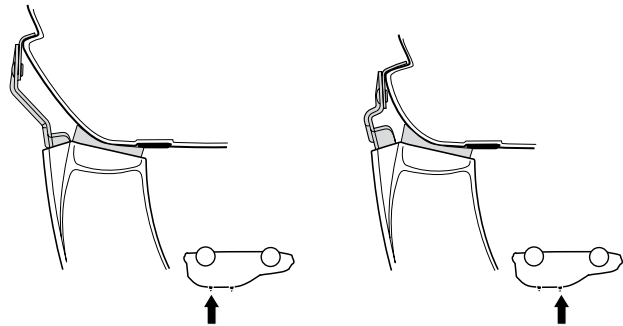

| | | | | |
|--|--------|--------|---------|---------|
| MITSUBISHI Triton, 2-dr Crew Cab, 05-09, 10- | 265 mm | 620 mm | 10 3/8" | 24 3/8" |
| MITSUBISHI L200, 2-dr Crew Cab, 05-09, 10- | 265 mm | 620 mm | 10 3/8" | 24 3/8" |
| | X mm | Y mm | X inch | Y inch |

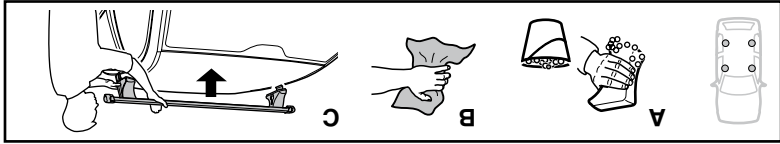

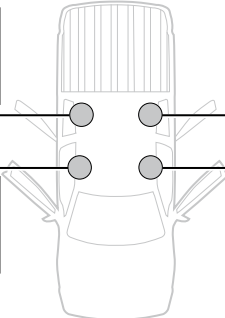
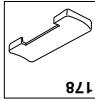
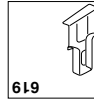
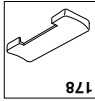
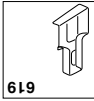
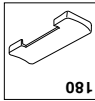
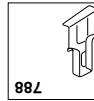
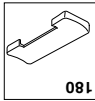
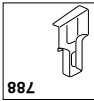
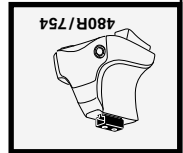
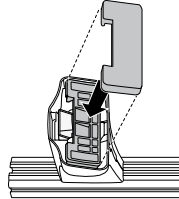
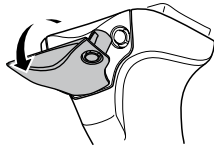
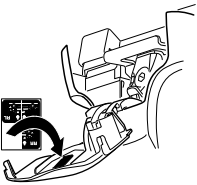
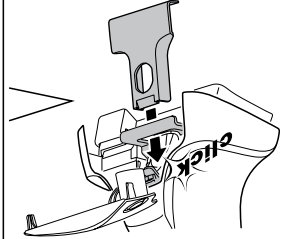
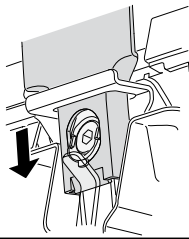
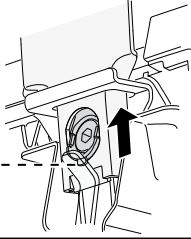
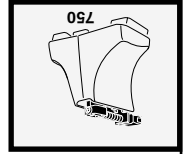
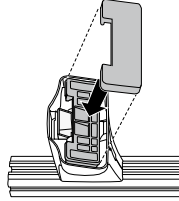
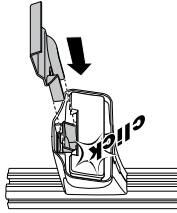
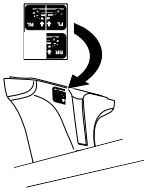

MITSUBISHI L200, 2-dr Crew Cab, 05-09, 10-
MITSUBISHI Triton, 2-dr Crew Cab, 05-09, 10-

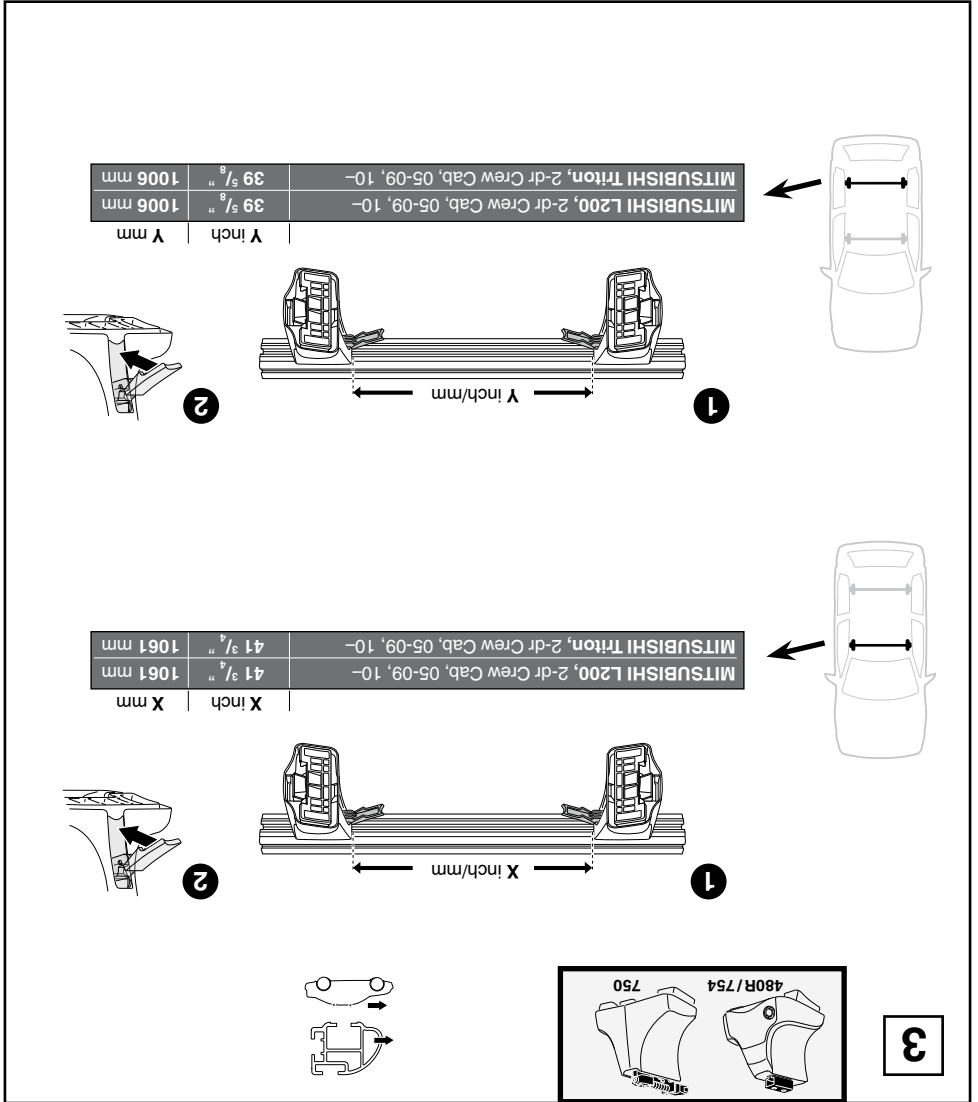
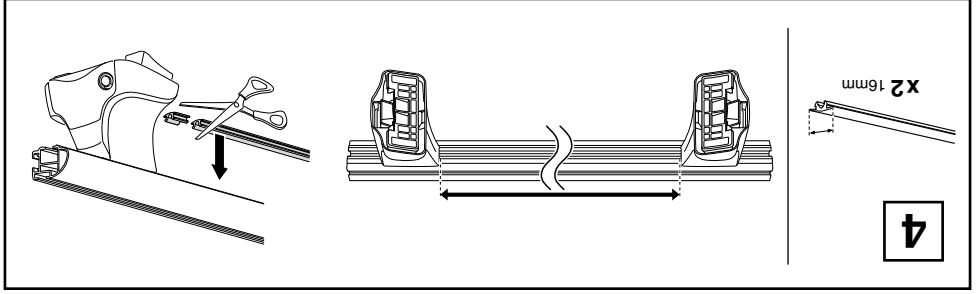

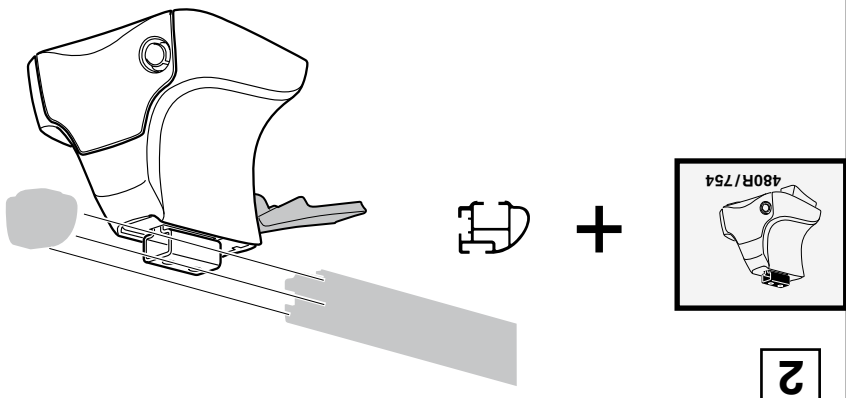
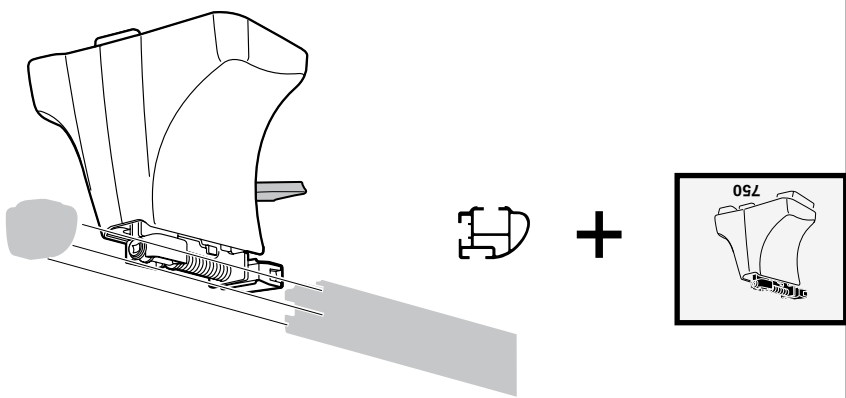

2

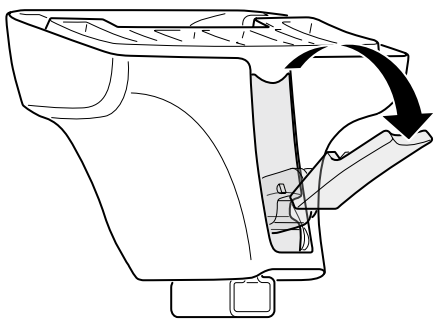

1

Kit

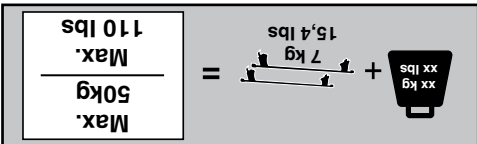
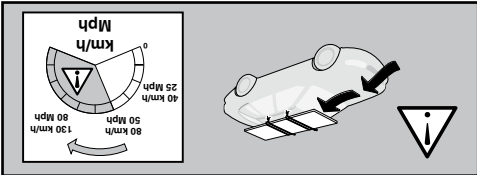
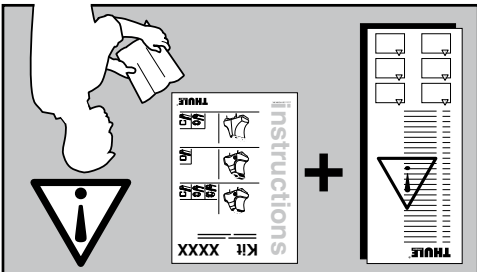
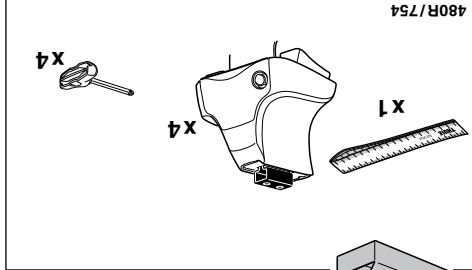
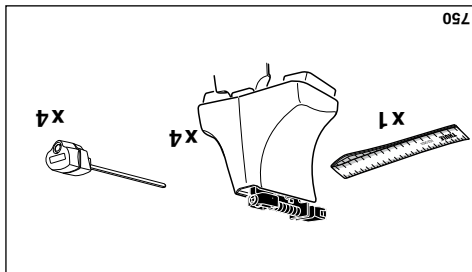
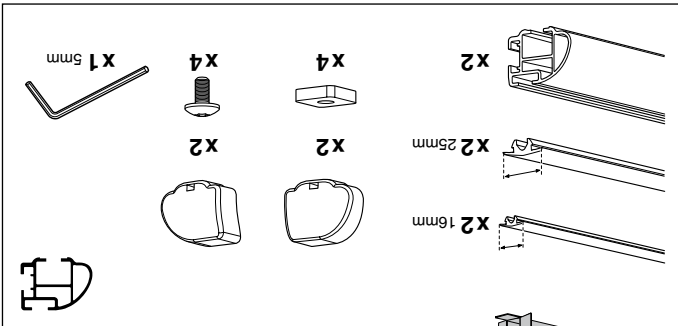
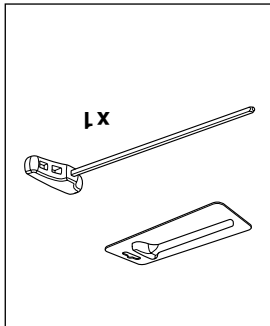
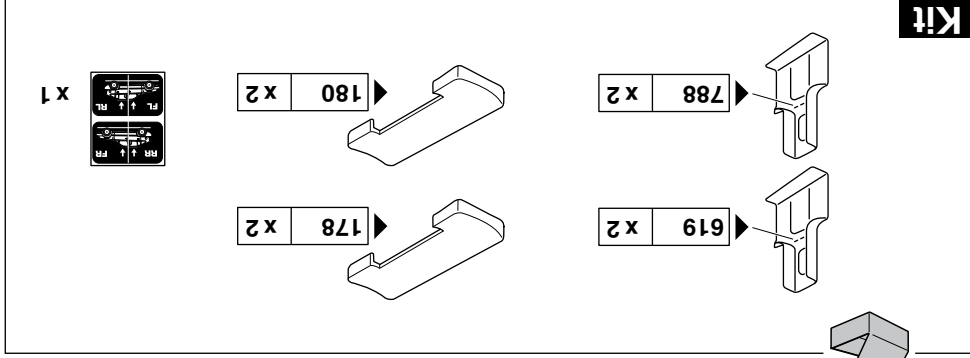

instructions

Kit 1401

MITSUBISHI L200, 2-dr Crew Cab, 05-09, 10-
MITSUBISHI Triton, 2-dr Crew Cab, 05-09, 10-

480R
754

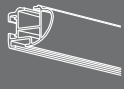
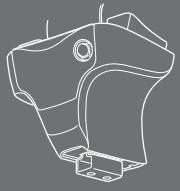

750

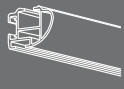
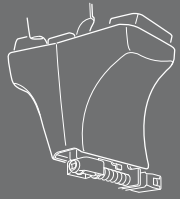

ISO 11154-E

THULE
SWEDEN
PROFESSIONAL