

Installation Manual

FORD S-MAX 5DR
FOR-SMAX-5-C



COMPONENTS INCLUDED

SHADES

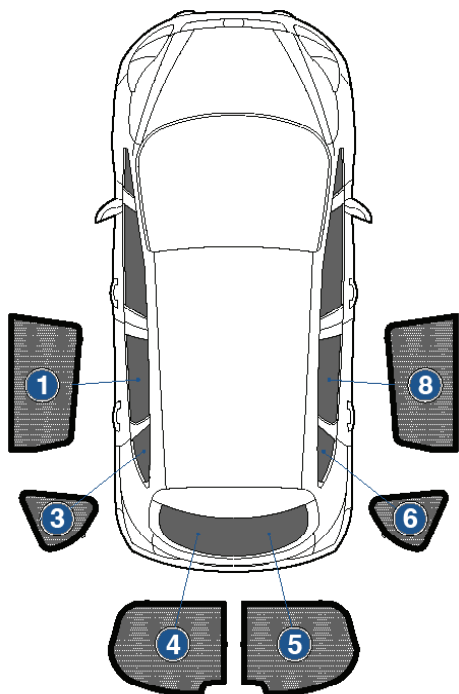

FIXING CLIPS



CL-M03 x 4



CL-M12 x 10



CL-M14 x 1

Side Shade Installation

FORD S-MAX 5DR
FOR-SMAX-5-C

COMPONENTS NEEDED:



STEP #1

ATTACH CLIPS ON SHADE EDGES



STEP #2

POSITION THE SIDE SHADE

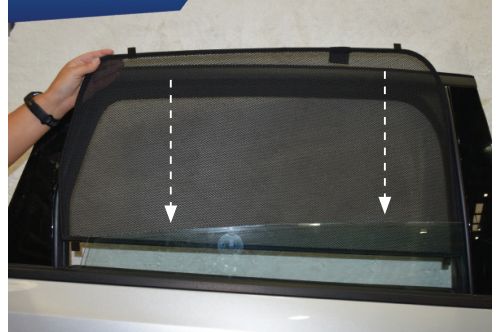

STEP #3

INSERT CLIPS INSIDE WEATHERSTRIP



STEP #4

ENSURE SECURELY FITTED IN PLACE

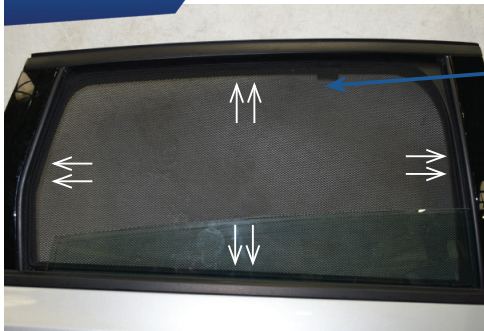

CAR
SHADES

Quarter Light Shade Installation

FORD S-MAX 5DR
FOR-SMAX-5-C

COMPONENTS NEEDED:



STEP #1 ENSURE SECURELY FITTED IN PLACE



Rear Shade Installation

FORD S-MAX 5DR

FOR-SMAX-5-C

COMPONENTS NEEDED:



STEP #1

ATTACH CLIPS ON SHADE EDGES



STEP #2

POSITION THE REAR SHADE

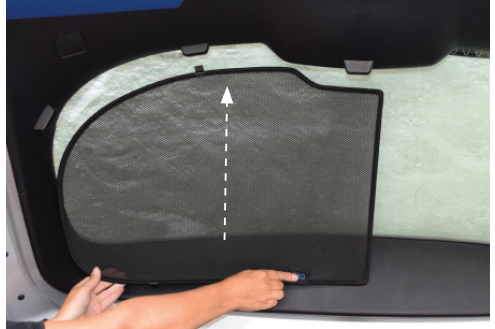

STEP #3

INSERT CLIPS BEHIND INTERIOR TRIM

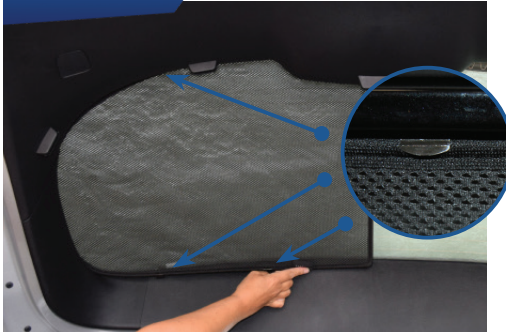

STEP #4

REPEAT THE PROCESS ON OTHER SHADE

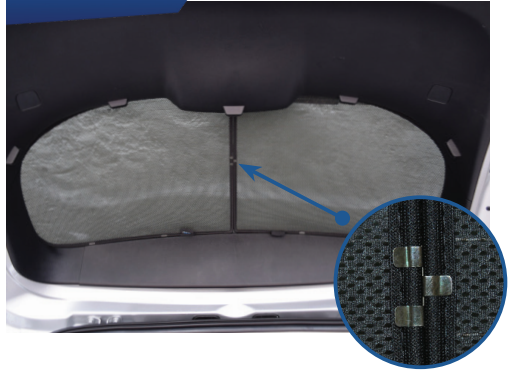

STEP #5

ENSURE SECURELY FITTED IN PLACE

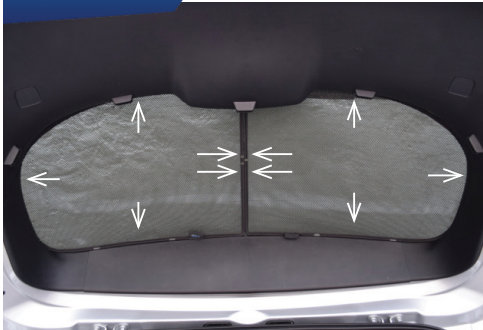

CAR
SHADES