

# Installation Manual

HYUNDAI TUCSON 5DR  
HYU-TUCS-5-C



## COMPONENTS INCLUDED

## SHADES

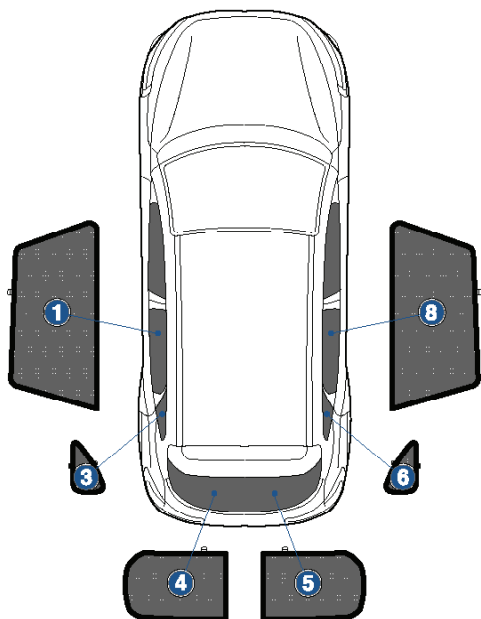

## FIXING CLIPS



CL-M02 x 4



CL-M12 x 4



CL-M13 x 4



CL-M14 x 1

# Side Shade Installation

HYUNDAI TUCSON 5DR  
HYU-TUCS-5-C

COMPONENTS NEEDED:



CL-M12 x 1



CL-M13 x 2

## STEP #1

ATTACH CLIPS ON SHADE EDGES

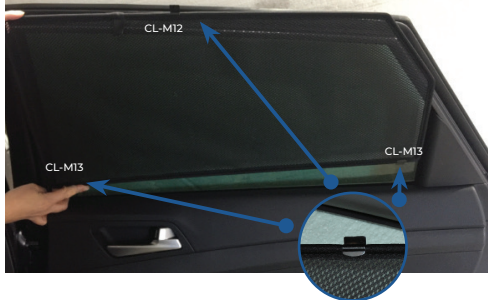

## STEP #2

POSITION THE SIDE SHADE

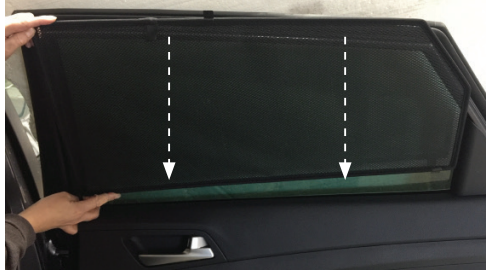

## STEP #3

INSERT CLIPS INSIDE WEATHERSTRIP

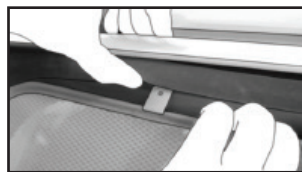

## STEP #4

ENSURE SECURELY FITTED IN PLACE

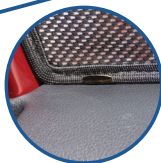

# Quarter Light Shade Installation

HYUNDAI TUCSON 5DR  
HYU-TUCS-5-C

COMPONENTS NEEDED:



## STEP #1

ATTACH CLIPS ON SHADE EDGES



## STEP #2

INSERT CLIPS BEHIND INTERIOR TRIM

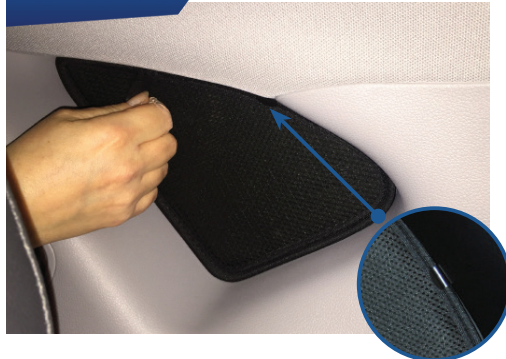

## STEP #3

ENSURE SECURELY FITTED IN PLACE

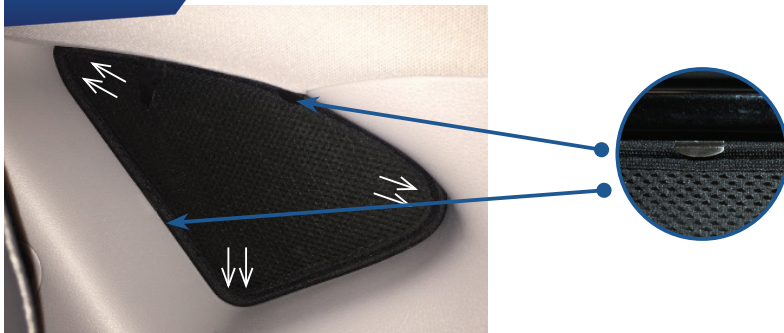

**CAR**  
SHADES

# Rear Shade Installation

HYUNDAI TUCSON 5DR  
HYU-TUCS-5-C

COMPONENTS NEEDED:



## STEP #1

ATTACH CLIPS ON SHADE EDGES



## STEP #2

POSITION THE REAR SHADE

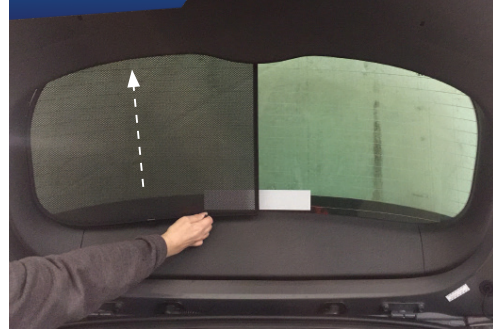

## STEP #3

INSERT CLIPS BEHIND INTERIOR TRIM



## STEP #4

REPEAT THE PROCESS ON OTHER SHADE

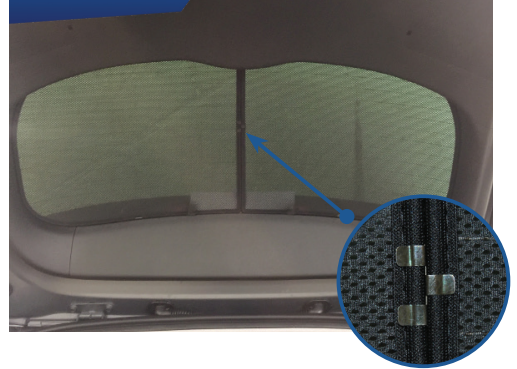

## STEP #5

ENSURE SECURELY FITTED IN PLACE

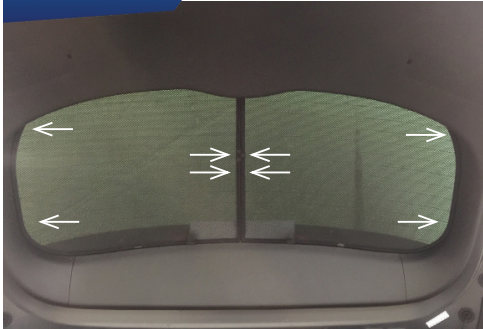

**CAR**  
SHADES