

Installation Manual

LANCIA YPSILON 3DR
LAN-YPSI-3-A



COMPONENTS INCLUDED



SIDE WINDOWS X2

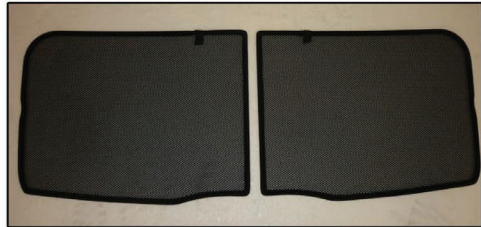

TAILGATE WINDOW X2

FIXING CLIPS



CL-M02 x 10



CL-M12 x 2

CAR[®]
S H A D E S

Installation

LANCIA YPSILON 3DR

LAN-YPSI-3-A



SIDE SHADE INSTALLATION

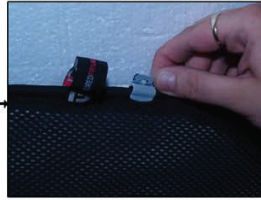
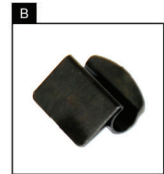
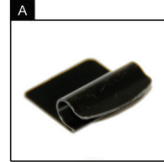
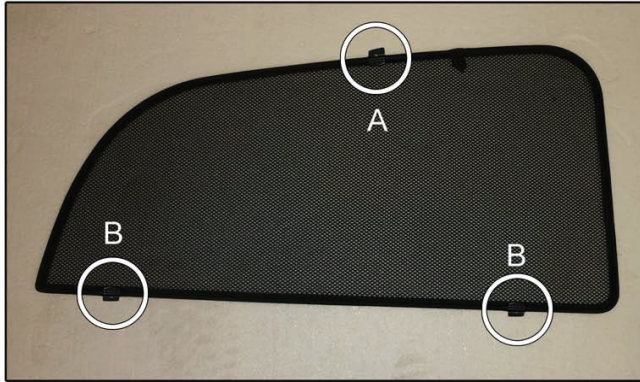

Installation

LANCIA YPSILON 3DR
LAN-YPSI-3-A

SIDE SHADE INSTALLATION

COMPONENTS NEEDED:



CL-M12 x 1



CL-M02 x 2



STEP #1

ATTACH CLIPS ON SHADE EDGES

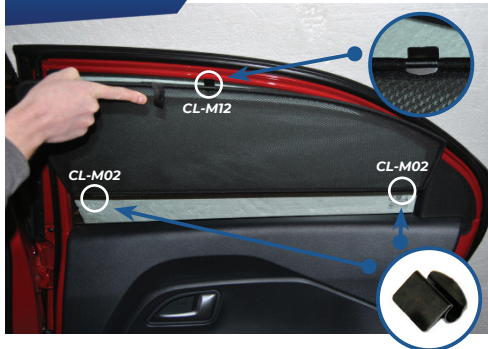

STEP #2

POSITION THE SIDE SHADE

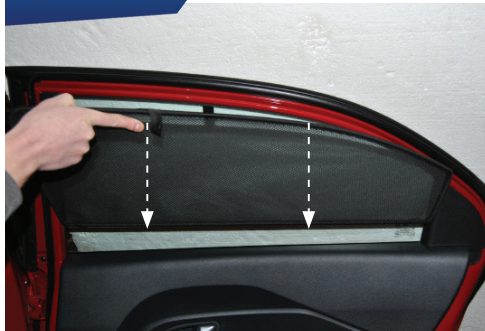

STEP #3

INSERT CLIPS INSIDE WEATHERSTRIP

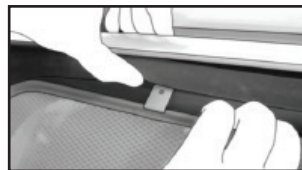

STEP #4

ENSURE SECURELY FITTED IN PLACE

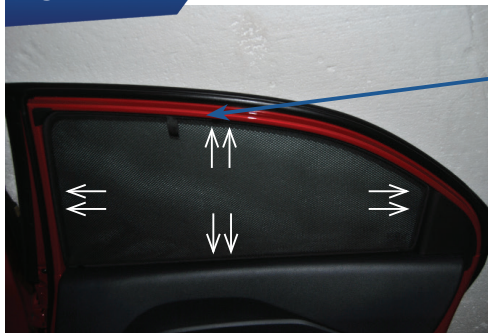

CAR
SHADES

Installation

LANCIA YPSILON 3DR

LAN-YPSI-3-A



TAILGATE SHADE INSTALLATION

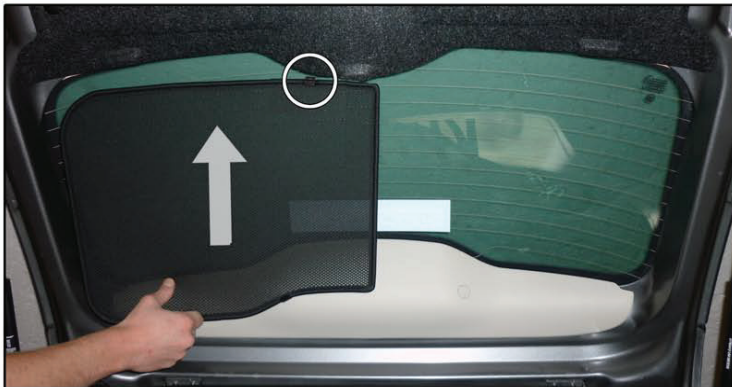
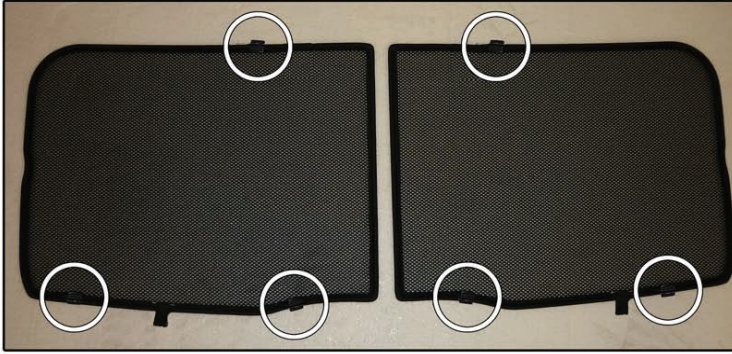

Installation

LANCIA YPSILON 3DR

LAN-YPSI-3-A



TAILGATE SHADE INSTALLATION

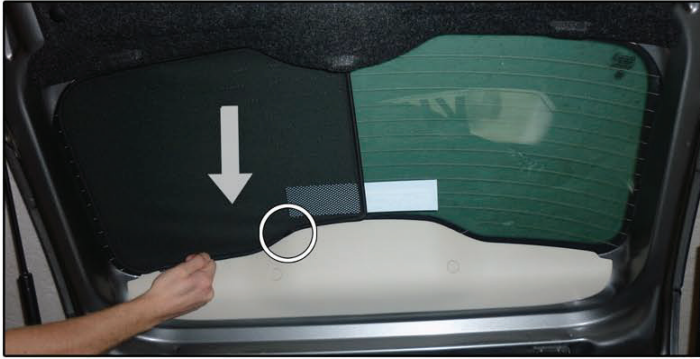

X2



Installation

LANCIA YPSILON 3DR

LAN-YPSI-3-A



TAILGATE SHADE INSTALLATION

